

MAINTENANCE DREDGING VOLUME SUMMARY TABLE				
DREDGING AREA	AREA TO BE DREDGED (SQ. FT.)	TOTAL VOLUME TO BE DREDGED (CU.FT.)	TOTAL VOLUME TO BE DREDGED (CU. YD.)	
PROPOSED NORTH 1	36,416.07 SQ. FT.	17,834.90	660.55	
PROPOSED NORTH 2	55,033.92 SQ. FT.	51,200.90	1,896.33	
PROPOSED SOUTH 1	22,067.91 SQ. FT.	12,503.40	463.09	
PROPOSED SOUTH 2	9,279.22 SQ. FT.	4,920.48	182.24	
TOTAL	122,797.12 SQ. FT.	86,459.68	3,202.21	

* DREDGING PART OF REQUEST TO USACE
INDIVIDUAL PERMIT (IP) 2021. NJDEP
PERMITTED WFAIP NO. 1516-02-0013.8
(WFD180001) REMAINS VALID.

LEGEND	
—52—	EXISTING CONTOUR
X -5.08	EXISTING SPOT ELEVATION
---	PROP. LIMIT OF DREDGING
---	PROPERTY BOUNDARY
---	PIERHEAD LINE
---	BULKHEAD LINE

PROPOSED DREDGING NOTES:

- TOTAL AREA OF MAINTENANCE DREDGING PROPOSED: 122,797.11 SF (2.82 AC)
- MAINTENANCE DREDGING DEPTH: -5.0 BELOW MLW
- NO DISTURBANCE TO OCCUR IN THE SURROUNDING UPLAND AREAS.
- APPROXIMATELY 600-800 CY IS EXPECTED TO BE MAINTAINED WITHIN THE MARINA ON AN ANNUAL BASIS AND LOCATION OF REMOVAL MAY VARY WITHIN THE DESIGNATED AREAS OF CONCERN FROM YEAR TO YEAR

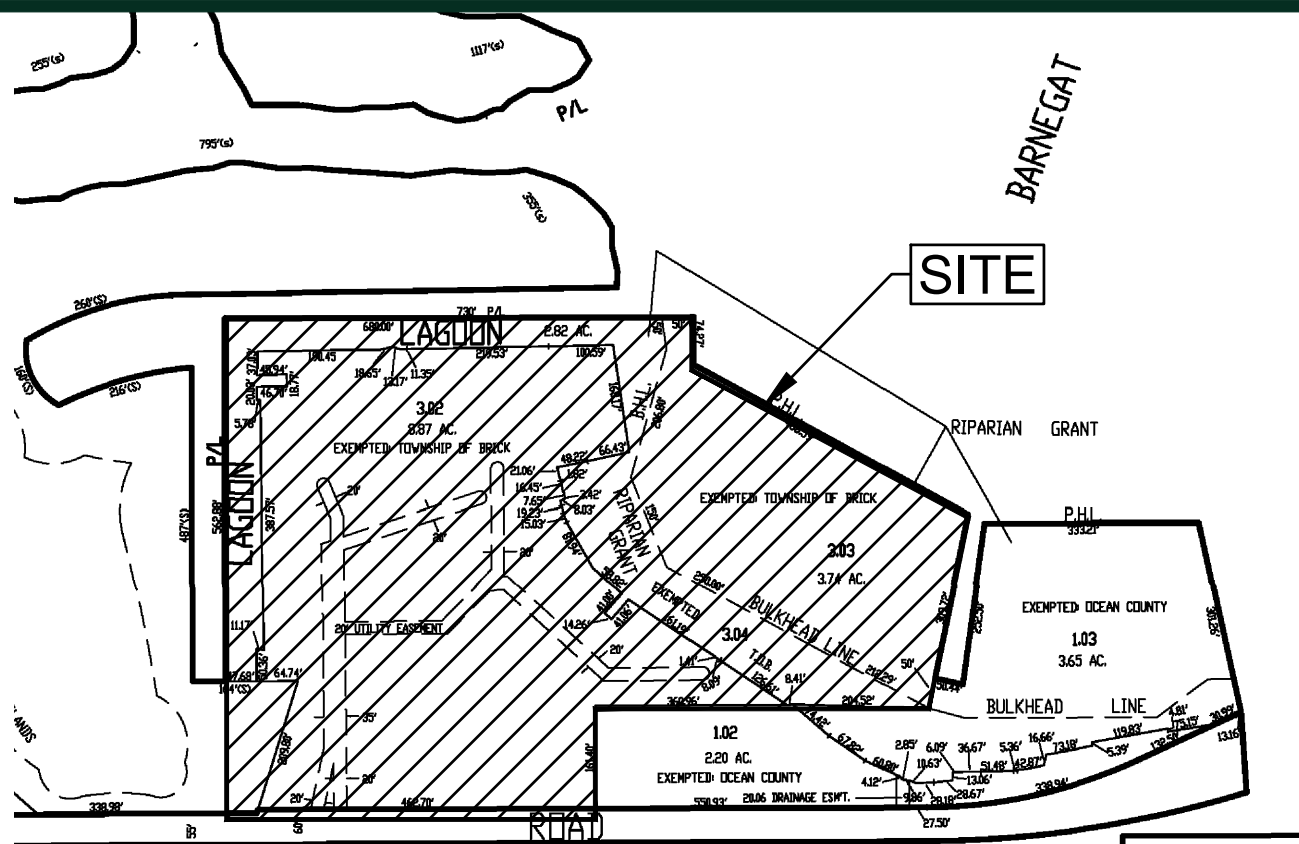

BRICK TOWNSHIP TAX MAP- SHEET 12
DATED OCTOBER 1, 1950
SCALE: 1"=300'



USGS QUADRANGLE- POINT PLEASANT 2016
SCALE: 1"=2000'

BATHYMETRIC SURVEY NOTES:

- THE HORIZONTAL DATUM IS REFERENCED TO THE NJ STATE PLANE COORDINATE SYSTEM, NAD 1983 AND THE ELEVATION DATUM IS THE NORTH AMERICAN VERTICAL DATUM OF 1988 BASED ON OBSERVATIONS WITH A TRIMBLE R10 GNSS NETWORK ROVER. THE REAL TIME CORRECTIONS WERE PROVIDED BY KEYNETGPS, A TRIMBLE VIRTUAL REFERENCE STATION NETWORK.
- THE SOUNDINGS WERE COLLECTED USING A DUAL FREQUENCY, SINGLE BEAM ECHOSOUNDER AND PROCESSED WITH HYPACK SOFTWARE TO NORTH AMERICAN VERTICAL DATUM OF 1988 ELEVATIONS.
- SUBMARINE AND/OR UNDERGROUND UTILITIES ARE NOT NECESSARILY COMPLETE AND MUST BE FIELD VERIFIED PRIOR TO CONSTRUCTION.
- THE SOUNDING INFORMATION DEPICTED HEREON WAS COLLECTED THE FIRST WEEK OF JANUARY, 2019 AND CAN ONLY BE CONSIDERED AS THE GENERAL CONDITIONS AT THAT TIME.
- THE SOUNDING DATA HAS BEEN OVERLAID ON A DIGITAL ORTHO IMAGE OBTAINED FROM THE NJ OFFICE OF INFORMATION TECHNOLOGY (NJGIT), OFFICE OF GEOGRAPHIC INFORMATION SYSTEMS (OGIS). THE REFERENCE DATE FOR THIS DATA SET IS 2015. TEMPORAL CHANGES MAY HAVE OCCURRED SINCE THIS DATA SET WAS COLLECTED AND THAT SOME PARTS OF THIS DATA MAY NO LONGER REPRESENT ACTUAL SURFACE CONDITIONS. THIS DATA SHOULD NOT BE USED FOR CRITICAL APPLICATIONS WITHOUT INSPECTING CURRENT CONDITIONS.
- CONTOURS WITHIN DOCK AND SLIP AREAS ARE APPROXIMATE AND HAVE NOT BEEN FIELD SURVEYED.

GENERAL NOTES

- KNOWN AND DESIGNATED AS BLOCK 68, LOTS 3.01 (FORMERLY LOT 3, 50.02 & 51), 3.02 (FORMERLY LOT 3.01), & 3.04 AS SHOWN ON THE CURRENT TAX ASSESSMENT MAP OF BRICK TOWNSHIP, OCEAN COUNTY, NEW JERSEY, OCT. 1, 1950, SHEET NO. 12.
- THESE PLANS HAVE BEEN PREPARED TO ADDRESS THE CONCERNS AND LEGALIZATION OF AREA USES FOR THE TOWNSHIP OF BRICK'S TRADER'S COVE MARINA IN ACCORDANCE WITH A MEETING CONDUCTED ON 11/05/2020. APPLICATIONS INCLUDING: USACE INDIVIDUAL PERMIT (IP) - AUTHORIZATION OF MAINTENANCE DREDGING ACTIVITIES, USE OF JET SKI AND SMALL CRAFT DOCKING SYSTEMS, ALONG WITH THE LEGALIZATION OF THE DOCKING SYSTEM CONFIGURATION THAT EXISTS AT THE MARINA. (NAP2012-00487). IN ADDITION, NJDEP WATERFRONT DEVELOPMENT INDIVIDUAL PERMIT (WFDIP) TO LEGALIZE CONFIGURATIONS OF NOTED AREAS, AND AUTHORIZATION OF JET SKIS AND SMALL WATERCRAFT DOCKING SYSTEMS. ALSO, INCLUDED IS THE REQUEST FOR APPROVAL OF A POLICE EMERGENCY BOAT LIFT SYSTEM WITHIN THE WESTERN LAGOON AREA (AREA 4).
- LOT AND BLOCK NUMBERS, ALONG WITH STREET AND WATERWAY NAMES SHOWN HEREON, ARE AS SHOWN ON THE CURRENT TAX ASSESSMENT MAP OF BRICK TOWNSHIP, OCEAN COUNTY, NEW JERSEY, OCT. 1, 1950, SHEET NO. 12.
- NJDEP 2007 ORTHOMETRIC AERIAL PHOTOGRAPHY REFERENCE: "THIS MAP WAS DEVELOPED USING NEW JERSEY DEPARTMENT OF ENVIRONMENTAL PROTECTION GEOGRAPHIC INFORMATION SYSTEM DIGITAL DATA, BUT THIS SECONDARY PRODUCT HAS NOT BEEN VERIFIED BY NJDEP AND IS NOT STATE AUTHORIZED."
- HYDROGRAPHIC SURVEY WAS PERFORMED BY VARGO ASSOCIATES IN JANUARY 2019.
- THIS PLAN IS A GRAPHICAL REPRESENTATION OF EXISTING LOT LINES AND IS NOT INTENDED TO BE USED AS A BOUNDARY LINE SURVEY. THIS REPRESENTATION IS BASED UPON THE CURRENT TAX ASSESSMENT MAP LISTED HEREON.

TIDAL ELEVATION

REFERS TO NAVD 1988

MEAN HIGHER HIGH WATER	0.46'
MEAN HIGH WATER	0.33'
MEAN TIDE LEVEL	0.16'
NAVD 1988	0.00'
MEAN LOW WATER	0.19'
MEAN LOWER LOW WATER	-0.10'
NGVD 1929	-1.11'

TIDAL ELEVATION BASED ON CONTROL TIDE STATION "853-2786 MANTOLOKING, BARNEGAT BAY, NEW JERSEY".

THE BENCH MARK ELEVATIONS SHOWN ABOVE ARE BASED SOLELY UPON PUBLISHED INFORMATION AND WERE NOT FIELD VERIFIED.

- FOR AREAS 1 THROUGH 4 (SEE SHEET 1A FOR DETAILS) ARH ASSOCIATES COMPLETED LIMITED SURVEY IN MAY/JUNE 2021 CONFIRMING CONFIGURATION DATA.

MAP REFERENCES

- MAP ENTITLED "MINOR SUBDIVISION PLAN MANTOLOKING COVE MARINA LOTS 1, 1.01, 2, 3, 3.01, 50.02, 50.03 & 51 BLOCK 68 TOWNSHIP OF BRICK, OCEAN COUNTY, NEW JERSEY" PREPARED BY BIRDSALL ENGINEERING, INC. LAST REVISED ON 8/23/07.
- MAP ENTITLED "CONSTRUCTION PLAN - RECONSTRUCTION OF TRADER'S COVE MARINA FLOATING DOCKS AND BREAKWATER BRICK TOWNSHIP, OCEAN COUNTY, NEW JERSEY" BIRDSALL SERVICES GROUP DATED 1/30/2013.

ADAMS, REHMAN & HEGGAN
ASSOCIATES, INC.
215 BELLEVUE AVENUE
PO BOX 579
HAMMONTON, NJ 08037-2019
TEL (609) 581-0482
FAX (609) 581-8809

ADAMS, REHMAN & HEGGAN
ASSOCIATES, INC.
215 BELLEVUE AVENUE
PO BOX 579
HAMMONTON, NJ 08037-2019
TEL (609) 581-0482
FAX (609) 581-8809

ADAMS, REHMAN & HEGGAN
ASSOCIATES, INC.
215 BELLEVUE AVENUE
PO BOX 579
HAMMONTON, NJ 08037-2019
TEL (609) 581-0482
FAX (609) 581-8809

REVISED PER ACCE	12-01-21
REVISED PER ACCE	1-03-21
REVISED PER ACCE	8-20-21
REVISED PER ACCE	6-30-21
REVISED PER ACCE	2-8-19

DREDGING LIMIT PLAN
FOR
TRADER'S COVE MARINA
MAINTENANCE DREDGING & MARINA IMPROVEMENTS
BLOCK 68, LOTS 3.01 (FORMERLY 3, 50.02 & 51), 3.03 (FORMERLY 3.01) & 3.04
TOWNSHIP OF BRICK - OCEAN COUNTY - NEW JERSEY

DATE	JULY 2021
SCALE	1" = 50'
DRAWN BY	CP
CHECKED	DHP
PROJ. NO.	2504018