

# **PUBLIC NOTICE**

## **REQUEST FOR PERMISSION TO ALTER A U.S. ARMY CORPS OF ENGINEERS PROJECT UNDER SECTION 408**

**TITLE:** Borough of Wildwood Crest - Reconstruct and Extend the Wildwood Crest Fishing Pier at the Atlantic Ocean at the Hereford Inlet to Cape May Inlet Coastal Storm Risk Management Federal Civil Works Project in the Borough of Wildwood Crest, Cape May County, New Jersey

**PUBLIC NOTICE IDENTIFICATION NUMBER:** 408-NAP-2026-0014

### **PUBLIC NOTICE COMMENT PERIOD:**

Begins: **02 June 2026**

Expires: **17 June 2026**

Interested parties are hereby notified that an application has been received for a Department of the Army Section 408 permission for certain work at or near a federal project of the United States, as described below and shown on attached figures. Written comments are being solicited from anyone having an interest in the requested alteration. Comments will become part of the U.S. Army Corps of Engineers' (USACE's) administrative record and will be considered in determining whether to approve the request. Comments supporting, opposing, or identifying concerns that should be considered by the USACE in its decision process are all welcome.

This public notice is not a paid advertisement and is for public information only. Issuance of this notice does not imply USACE endorsement of the project as described.

**1. REQUESTOR:** In compliance with 33 USC 408 (Section 14 of the Rivers and Harbors Act of 1899; hereinafter Section 408), the Borough of Wildwood Crest has requested permission to undertake the Wildwood Crest Fishing Pier Reconstruction and Extension Project sited within the authorized but unconstructed Hereford Inlet to Cape May Inlet Coastal Storm Risk Management Federal Civil Works Project.

**2. LOCATION:** The proposed project is located at the Atlantic Ocean at the eastern terminus of East Heather Road in the Borough of Wildwood Crest, Cape May County, New Jersey; approximate center coordinates 38.973592, -74.823157.

**3. LOCATION MAP(S)/DRAWING(S):** Please see attached Project Plan Sheets 1 - 9.

**4. REQUESTER'S PROPOSED ACTION:** The proposed action entails reconstruction and extension of the existing Wildwood Crest fishing pier. Specifically, the following is proposed: reconstruction of the existing fishing pier to 16.0-feet in width with a new archway sign and beach access stairs; and construction of one (1) new, 16.0-foot wide by 1,250.0-foot-long

fixed pier extension to include two (2) 30.0-foot wide by 50.0-foot long fishing platforms along the pier extension and one (1) 30.0-foot wide by 50.0-foot long platform at the seaward end of the pier extension. The section of the pier to be reconstructed that crosses the existing dune will not exceed 8.0-feet in width. The pier extension will extend 850.0-linear feet seaward into the Atlantic Ocean as measured from the Mean High Water Line.

The existing pier and its proposed extension are sited within the authorized but unconstructed Hereford Inlet to Cape May Inlet Coastal Storm Risk Management Federal Civil Works Project.

The stated purpose of the project is to extend the existing fishing pier back into the Atlantic Ocean so that the pier can once again be utilized as intended, replace the existing structure which is nearing the end of its useful lifespan, and comply with the Americans with Disabilities Act (ADA) by allowing for the beachfront and ocean to be accessible to all pedestrians.

**5. REGULATORY AUTHORITY:** This request will be reviewed according to the provisions of Section 14 of the Rivers and Harbors Act of 1899 (33 U.S.C. 408). A requestor has the responsibility to acquire all other permissions or authorizations required by federal, state, and local laws or regulations, including any required permits from the USACE Regulatory Program under Section 10 of the Rivers and Harbors Act of 1899 (33 USC 403), Section 404 of the Clean Water Act (33 USC Section 1344) and/or Section 103 of the Marine Protection, Research and Sanctuaries Act of 1972 (33 USC 1413). Any Section 10/404/103 permit decision associated with the proposed alteration is separate from and will not be included in the Section 408 permission decision. An approval under Section 408 does not grant any property rights or exclusive privileges nor does it authorize any injury to the property or rights of others.

**6. ENVIRONMENTAL COMPLIANCE:** A decision on a Section 408 request is a federal action, and therefore subject to the National Environmental Policy Act (NEPA) and other environmental compliance requirements. While ensuring compliance is the responsibility of USACE, the requester is providing all information that the Philadelphia District identifies as necessary to satisfy all applicable federal laws, executive orders, regulations, policies, and ordinances. Based on information provided by the applicant to date, current Corps regulations governing NEPA implementation, and/or the contents of existing NEPA documentation if available, it is likely that the proposed action will be determined to be categorically excluded from the need to prepare an Environmental Assessment (EA) or Environmental Impact Statement (EIS). This determination will be finalized following completion of agency coordination and prior to issuance of the Section 408 Permission Decision.

**7. EVALUATION:** As part of its evaluation, USACE will first make a determination that the submittal from the requestor is complete. The Philadelphia District is working closely with the requestor to ensure that all required technical plans, maps, drawings, and specifications are provided and are complete. Once the package is complete, a District-led review will be conducted to determine, in accordance with Engineering Circular (EC) 1165-2-216, whether the proposed alteration will impair the usefulness of the USACE Project or be injurious to the public interest, as follows:

- A. *Impair the Usefulness of the Project Determination.* The Philadelphia District's Section 408 review team will determine if the proposed alteration will limit the ability of the federally authorized project to function as authorized, or will compromise or change any authorized project conditions, purposes or outputs.
  
- B. *Injurious to the Public Interest Determination.* Proposed alterations will be reviewed to determine the probable impacts, including cumulative impacts, on the public interest. Evaluation of the probable impacts that the proposed alteration to the USACE project may have on the public interest requires a careful weighing of all those factors that are relevant in each particular case. Factors that may be relevant to the public interest depend upon the type of USACE project being altered and may include, but are not limited to, such things as conservation, economic development, historic properties, cultural resources, environmental impacts, water supply, water quality, flood hazards, floodplains, residual risk, induced damages, navigation, shore erosion or accretion, and recreation. The decision whether to approve an alteration will be determined by the consideration of whether benefits are commensurate with risks. If the potential detriments are found to outweigh the potential benefits, then it may be determined that the proposed alteration is injurious to the public interest.

**8. SOLICITATION OF COMMENTS:** The USACE is soliciting comments from the public; federal, state, and local agencies and officials; Indian Tribes; and other interested parties in order to consider and evaluate the impacts of the proposed activity. Any comments received will be considered by USACE to determine whether to issue, modify, condition, or deny a permission for this proposal. To make this decision, comments are used to assess impacts on endangered species, historic properties, water quality, general environmental effects, and other public interest factors listed above. Comments are considered in making a final determination whether the proposed action will be categorically excluded from the need to prepare further NEPA documentation. Comments are also used to determine the need for a public hearing and to determine the overall public interest of the proposed activity.

- A. It should be noted that materials submitted as part of the Section 408 request become part of the public record and are thus available to the general public under the procedures of the Freedom of Information Act (FOIA). Individuals may submit a written request to the Philadelphia District Corps of Engineers, Office of Counsel to obtain copies of said materials under the FOIA.
  
- B. It is presumed that all parties viewing this notice will wish to respond to this public notice; therefore, a lack of response will be interpreted as meaning that there is no objection to the project as described.

**9. COMMENT SUBMISSION AND ADDITIONAL INFORMATION:** Written comments on the described work should reference the USACE Public Notice Identification Number found on the first page of this notice. Comments must reach this office no later than the stated expiration date of the Public Notice to become part of the record and be

considered in the decision. Comments or requests for additional information should be emailed or mailed to the following address:

Email: [Bishel.Baby@usace.army.mil](mailto:Bishel.Baby@usace.army.mil)  
U.S. Army Corps of Engineers  
Philadelphia District  
Attn: Bishel B. Baby  
1650 Arch Street, 7th Floor  
Philadelphia, PA 19103-2004

# WILDWOOD CREST FISHING PIER REPLACEMENT AND EXPANSION (CAFRA PERMIT)

UTILITIES	
<b>PUBLIC WORKS:</b>	WILDWOOD CREST PUBLIC WORKS DEPARTMENT STEVE SHEARER 120 W. NEWARK AVENUE WILDWOOD CREST, NJ 08260 609-522-7446
<b>SEWER:</b>	WILDWOOD CREST SEWER DEPARTMENT STEVE SHEARER 120 W. NEWARK AVENUE WILDWOOD CREST, NJ 08260 609-522-7446 CAPE MAY COUNTY M.U.A. THOMAS J. LAROCO, P.E. 1523 ROUTE 9 NORTH, PO BOX 610 CAPE MAY COURT HOUSE, NJ 08210 609-465-9026
<b>WATER:</b>	WILDWOOD WATER UTILITY KEITH LAMB 3416 PARK BOULEVARD WILDWOOD, NJ 08260 609-546-0600
<b>ELECTRIC:</b>	ATLANTIC CITY ELECTRIC COMPANY GREG DOMSIC 420 ROUTE 9 NORTH CAPE MAY COURT HOUSE, NJ 08210 609-463-3816
<b>CABLE:</b>	COMCAST CABLE TONY VOROS 1846 NW BOULEVARD VINELAND, NJ 08360 800-934-6489
<b>GAS:</b>	SOUTH JERSEY GAS COMPANY JEREMAH LIN 1708 ROUTE 9 NORTH CAPE MAY COURT HOUSE, NJ 08210 609-465-2900
<b>TELEPHONE:</b>	VERIZON ENGINEERING DEPARTMENT STEPHANIE WEBSTER 10 TANSBORO ROAD, FLOOR 2 BERLIN, NJ 08009 732-357-3021
<b>COUNTY ROADS:</b>	CAPE MAY COUNTY PUBLIC WORKS ROBERT CHURCH, P.E. 4 MOORE ROAD CAPE MAY COURT HOUSE, NJ 08210 609-465-1035

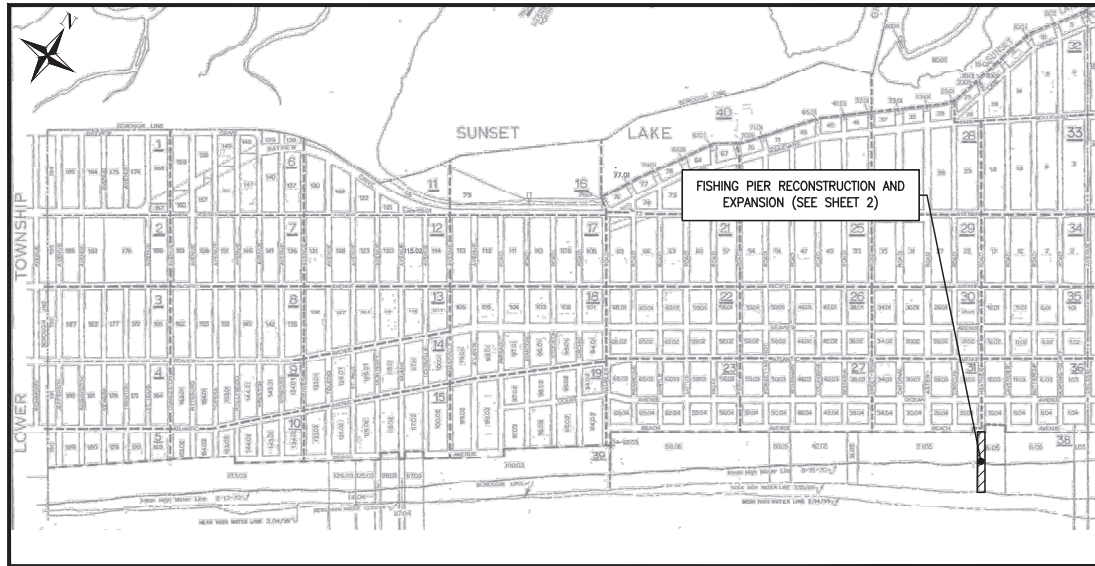

PROJECT LOCATION MAP



## BOROUGH OF WILDWOOD CREST CAPE MAY COUNTY, NEW JERSEY

INDEX OF SHEETS	
SHEET NO.	DESCRIPTION
1	TITLE SHEET (CAFRA PERMIT)
2	FISHING PIER REPLACEMENT & EXPANSION (CAFRA PERMIT)
3 - 4	CONSTRUCTION DETAILS (CAFRA PERMIT)

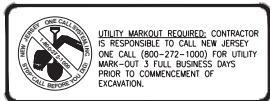
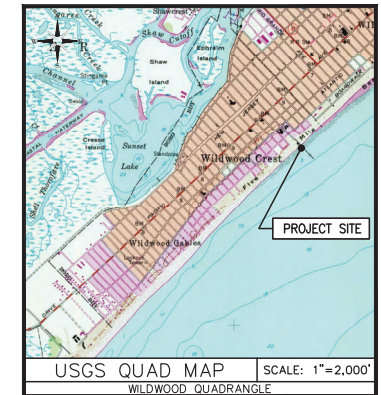

ISSUED FOR  
PERMITTING

NO.	DATE	APPR.	REASON

Version: JLM    Drawn: MCA    Check: MAD    Date: 6/25/25  
 Scale: AS NOTED    Project No: WCC-17-03    Sheet No: 1 of 4

COPYRIGHT 2025, DEBLASIO & ASSOCIATES, P.C. - ALL RIGHTS RESERVED. THE COPYING OR REUSE OF THIS DOCUMENT OR PORTIONS THEREOF, FOR OTHER THAN THE ORIGINAL PROJECT OR THE PURPOSE ORIGINALLY INTENDED, WITHOUT THE WRITTEN PERMISSION OF DEBLASIO & ASSOCIATES, P.C. IS PROHIBITED.

**MARC A. DEBLASIO, PE**    DATE  
 New Jersey License No. 41599  
 Wildwood Crest Fishing Pier Replacement and Expansion  
 Borough of Wildwood Crest  
 Cape May County, New Jersey

**TITLE SHEET  
(CAFRA PERMIT)**

**DeBlasio & Associates**  
CONSULTING ENGINEERS AND PLANNERS

4701 NEW JERSEY AVENUE  
WILDWOOD, NJ 08260  
PHONE: (609) 654-1311  
FAX: (609) 654-4323  
WWW.DEBLASIOANDASSOCIATES.COM  
Certification of Authorization No. 24CA2028490

WILDWOOD CREST FISHING PIER REPLACEMENT AND EXPANSION  
BOROUGH OF WILDWOOD CREST  
CAPE MAY COUNTY, NEW JERSEY

2019 N.J.D.O.T. STANDARD SPECIFICATIONS FOR ROADWAY AND BRIDGE CONSTRUCTION SHALL GOVERN, EXCEPT FOR THOSE DETAILS CONTAINED HEREIN

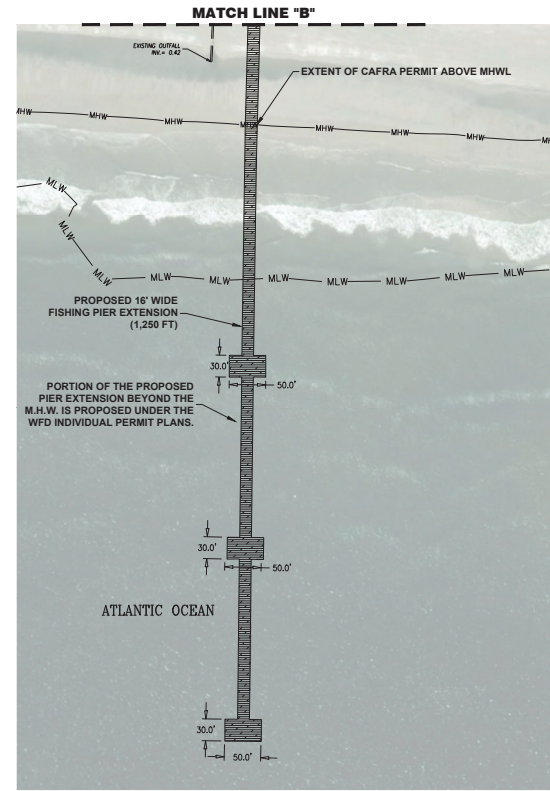

- NOTES:**
- EXISTING TOPOGRAPHIC INFORMATION SHOWN WAS BASED ON A FIELD SURVEY COMPLETED ON 06/19/2025 UNDER THE SUPERVISION OF HENRY V. ENGEL, N.J.P.L.S. LICENSE NO. 35833.
  - ELEVATIONS SHOWN ARE BASED ON NAVD88 DATUM.
  - HORIZONTAL CONTROL IS REFERENCED TO THE NEW JERSEY STATE PLANE COORDINATE SYSTEM (NAJ 1983).
  - PROPERTY AND RIGHT-OF-WAY LINES SHOWN ARE APPROXIMATE LOCATIONS BASED ON THE CURRENT TAX MAPS OF THE BOROUGH OF WILDWOOD CREST, CAPE MAY COUNTY, NEW JERSEY. SAID LINES ARE SHOWN FOR GRAPHICAL INFORMATION ONLY AND HAVE NOT BEEN FIELD VERIFIED.
  - DIGITAL ORTHOPHOTOGRAPHY SHOWN PROVIDED BY THE NJ OFFICE OF INFORMATION TECHNOLOGY (NOIT), OFFICE OF GEOGRAPHIC INFORMATION SYSTEMS (OGIS), DATED 2015.
  - TIDELANDS CLAIM LINE WAS OBTAINED FROM NEW JERSEY DEPARTMENT OF ENVIRONMENTAL PROTECTION GEOGRAPHIC INFORMATION SYSTEM DIGITAL DATA.

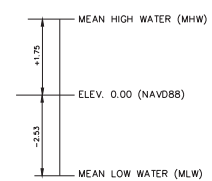

**NOTES:**  
1. TIDAL INFORMATION WAS TAKEN FROM NOAA DATUM VERSION 4.6.1 (NAVD 88).  
**TIDAL REFERENCE**  
N.T.S.

**ISSUED FOR PERMITTING**

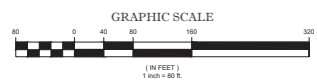

**FISHING PIER REPLACEMENT & EXPANSION (CAFRA PERMIT)**

**DeBlasio & Associates**  
CONSULTING ENGINEERS AND PLANNERS  
4701 NEW JERSEY AVENUE  
WILDWOOD, NJ 08260  
PHONE (609) 854-3311  
FAX (609) 854-4322  
WWW.DEBLASIOASSOC.COM  
Certification of Authorization No. 24CA20284900

**WILDWOOD CREST FISHING PIER REPLACEMENT AND EXPANSION**  
BOROUGH OF WILDWOOD CREST  
CAPE MAY COUNTY, NEW JERSEY

Version:	Drawn:	Check:	Date:
JLM	MCA	MAD	6/25/25

**MARC A. DEBLASIO, PE** DATE  
New Jersey License No. 41599

Scale: AS SHOWN  
Date: 6/25/25

COPYRIGHT 2025, DEBLASIO & ASSOCIATES, P.C. - ALL RIGHTS RESERVED. THE COPYING OR REUSE OF THIS DOCUMENT OR PORTIONS THEREOF, FOR OTHER THAN THE ORIGINAL PROJECT OR THE PURPOSE ORIGINALLY INTENDED, WITHOUT THE WRITTEN PERMISSION OF DEBLASIO & ASSOCIATES, P.C. IS PROHIBITED.

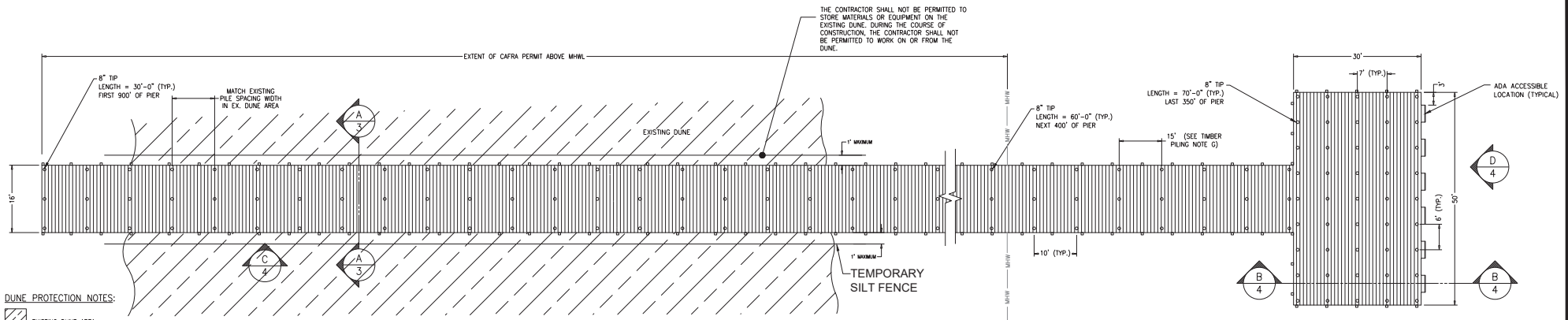

**DUNE PROTECTION NOTES:**

- 1. THE CONTRACTOR SHALL PRESERVE ALL EXISTING DUNE GRASS DURING THE COURSE OF CONSTRUCTION WORK. THE RE-ESTABLISHMENT OF DUNE GRASSES SHALL BE REQUIRED IN ALL DISTURBED AREAS.
- 2. ALL PROPOSED TIMBER PILES IN THE EXISTING DUNE AREA SHALL BE PLACED IN THE SAME LOCATION AS EXISTING TIMBER PILES WHERE FEASIBLE.
- 3. THE CONTRACTOR SHALL MAINTAIN THE ELEVATION OF THE DUNE AS ESTABLISHED IN THE EXISTING CONDITION. SAND SHALL NOT BE MOVED FROM THE DELINEATED DUNE AREA.

**FISHING PIER STRUCTURE**  
SCALE: N.T.S.

**TIMBER PILING NOTES:**

- A) PILING SHALL BE 8 INCH MINIMUM TIP DIAMETER NATURAL TAPER CONFORMING TO ASTM D25 CERTIFIED GREENHEART (CHLOROCARDIUM RODIC). PILES SHALL BE NEW AND FREE FROM ANY SPLITS, CHECKS, OR DEFORMATIONS WHICH REDUCE STRUCTURAL LOAD CARRYING CAPACITY. TIMBER PILES SHALL NOT BE SPLICED.
- B) PILES SHALL BE DRIVEN WITH A HAMMER DELIVERING A MINIMUM RATED ENERGY BETWEEN 8,000 AND 15,000 FT-LB. CONTRACTOR SHALL SUBMIT PROPOSED PILE DRIVING HAMMER EQUIPMENT INFORMATION AND WAVE EQUATION ANALYSIS FOR APPROVAL PRIOR TO STARTING WORK. PILES SHALL BE DRIVEN TO 8 TON CAPACITY AS VERIFIED BY ENGINEERING NEW RECORD FORMULA. ALL INSTALLED PILES SHALL BE CERTIFIED FOR CAPACITY BY A NJ LICENSED PROFESSIONAL ENGINEER.
- C) TWO 50 FT. TEST PILES SHALL BE DRIVEN BY THE CONTRACTOR AND WITNESSED BY THE ENGINEER PRIOR TO ORDERING PRODUCTION PILES. PILE ORDER LENGTH SHALL DEPEND ON THE TEST DRIVE BY THE CONTRACTOR. ALL PILES SHALL BE DRIVEN TO A MINIMUM TIP ELEVATION AND TERMINAL DRIVING RESISTANCE. MIN. TIP SHALL BE AS SHOWN (NAVD DATUM). TERMINAL DRIVING RESISTANCE SHALL BE AS SPECIFIED BY THE CERTIFYING ENGINEER AND BASED UPON THE CONTRACTOR'S DRIVING EQUIPMENT SUBMITTAL. THE CERTIFYING ENGINEER SHALL MAKE THE FINAL DETERMINATION OF FINAL PILE LENGTH, DRIVING CRITERIA, AND MAXIMUM STRUCTURAL CAPACITY.
- D) PILES MAY BE INSTALLED BY SPLUDGING OR JETTING WITH APPROVAL OF THE DESIGN ENGINEER. PRE-AUGERING SHALL BE PERMITTED TO 10 FT. BELOW GRADE. ALL PILES SHALL BE DRIVEN FROM 10 FT. BELOW GRADE TO THE MINIMUM TIP ELEVATION, THEN DRIVE PILES UNTIL CERTIFYING ENGINEER SPECIFIED TERMINAL RESISTANCE (BLOW COUNT) IS ACHIEVED OVER A DISTANCE OF 1 FOOT. PILES NOT MEETING THE DRIVE CRITERIA SHALL REST 24 - 48 HOURS BEFORE RESTRIKING. AFTER RESTRIKING, IF PILE STILL DOES NOT MEET DRIVE CRITERIA, SUSPEND DRIVING OPERATIONS AND CONTACT DESIGN ENGINEER.
- E) PILE CENTERLINES SHALL BE LOCATED WITHIN 3 INCHES OF PLAN DIMENSIONS AT THE CUT-OFF ELEVATION AS SHOWN ON THE DRAWINGS. PILE SHALL BE PLUMB AND NO GREATER THAN 1 INCH IN 10 FEET FROM THE VERTICAL WITH A MAXIMUM OF 4 INCHES OVER THE ENTIRE LENGTH OF THE PILE. FINAL PILE CUT-OFFS SHALL BE PERPENDICULAR TO THE PILE AXIS AND AS SHOWN ON THE DRAWINGS.
- F) HEAVED PILES SHALL BE RE-DRIVEN TO THE MINIMUM TIP ELEVATION AND SPECIFIED TERMINAL DRIVING RESISTANCE. MISALIGNED, DAMAGED, SPLIT OR OTHER PILING NOT MEETING THE SPECIFICATIONS HEREIN, SHALL BE REMOVED AND REPLACED AT THE CONTRACTORS EXPENSE.
- G) CONTRACTOR SHALL PROVIDE TWO FIFTY FOOT ACCESS POINTS FOR VEHICLE TRAVEL ON BEACH TO BE COORDINATED WITH THE NJDEP AND U.S. ARMY CORPS OF ENGINEERS.

**DESIGN CRITERIA:**

- A) NEW JERSEY UNIFORM CONSTRUCTION CODE N.J.A.C. 5:23 ET. SEQ.
- B) AMERICAN SOCIETY OF CIVIL ENGINEERS STANDARD ASCE/SEI 7-10 "MINIMUM DESIGN LOADS FOR BUILDINGS AND OTHER STRUCTURES"
- C) AMERICAN SOCIETY OF CIVIL ENGINEERS STANDARD ASCE/SEI 24-14 "FLOOD RESISTANT DESIGN AND CONSTRUCTION"
- D) LOADS (GRAVITY)  
EXTERIOR DECK LL = 100PSF
- E) WIND LOADING  
BASIC WIND SPEED (3-SECOND GUST) = 120 MPH  
OCCUPANCY CATEGORY = II IMPORTANCE FACTOR = 1.00  
EXPOSURE CATEGORY = D

**WOOD FRAMING**

- 1. PROVIDE ALL WOOD FRAMING MATERIALS SHOWN ON THE PLANS FOR COMPLETE CONSTRUCTION.
- 2. ALL WOOD FRAMING AND RAILING SHALL BE GREENHEART WOOD MATERIAL.
- 3. ALL EXPOSED CORNER EDGES ON TOP AND SIDE HANDRAILS TO BE ROUTED AND SANDED TO PROVIDE A SMOOTH FINISH.
- 4. ALL WOOD DECKING SHALL BE CUMARU (DIPTERYX ODORATA) (F<sub>o</sub> = 10,975 PSI).
- 5. SPACING BETWEEN DECKING SHALL NOT EXCEED 1/2".
- 6. NO OPENINGS SHALL BE MADE IN ANY STRUCTURAL MEMBER UNLESS SPECIFICALLY SHOWN ON THE STRUCTURAL DRAWING OR FROM THE ENGINEER.
- 7. ALL STAINLESS STEEL BOLTS, NUTS, WASHERS, THREADS, AND RODS SHALL BE ASTM A 276 GRADE 316.

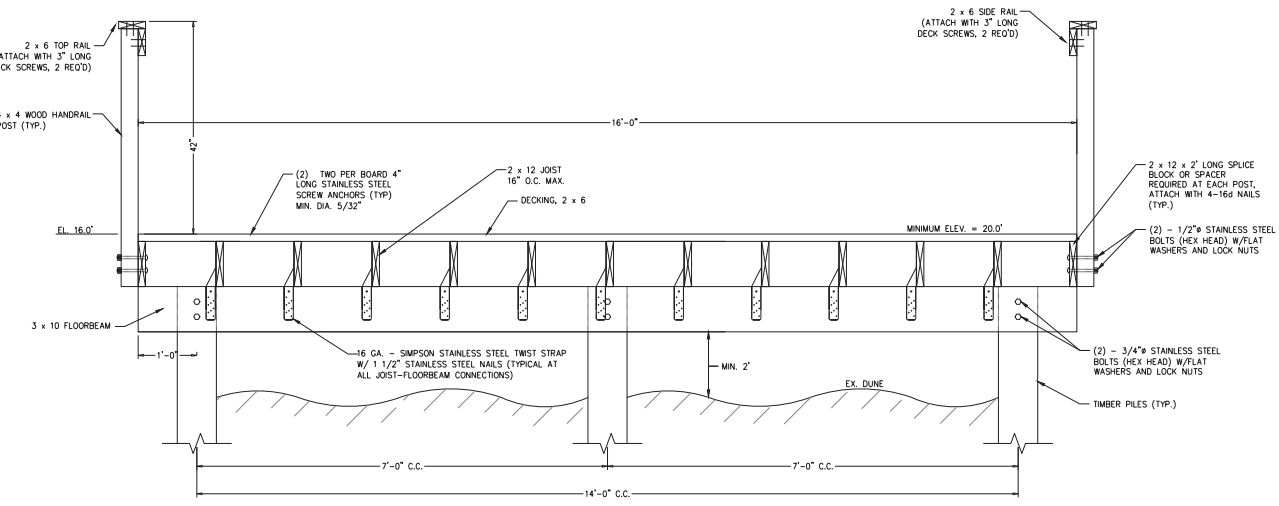

**TIMBER FISHING PIER**  
**(SECTION A-A)**  
SCALE: 1" = 1'-0"

**CONSTRUCTION DETAILS (CAFRA PERMIT)**

**DeBlasio & Associates**  
CONSULTING ENGINEERS AND PLANNERS  
4701 NEW JERSEY AVENUE  
MILWOOD, NJ 07060  
PHONE (609) 654-1311  
FAX (609) 654-4322  
WWW.DEBLASIOANDASSOCIATES.COM  
Certification of Administration No. 2642828900

**ISSUED FOR PERMITTING**

**WILDWOOD CREST FISHING PIER REPLACEMENT AND EXPANSION**  
BOROUGH OF WILDWOOD CREST  
CAPE MAY COUNTY, NEW JERSEY

Version:	Drawn:	Check:	Date:
JLM	MCA	MAD	6/25/25

**MARC A. DEBLASIO, PE** DATE  
New Jersey License No. 41599

Scale: AS NOTED  
Date: 6/25/25

NO.	DATE	APPROVAL	REVISION

COPYRIGHT 2025, DEBLASIO & ASSOCIATES, P.C. - ALL RIGHTS RESERVED. THE COPYING OR REUSE OF THIS DOCUMENT OR PORTIONS THEREOF, FOR OTHER THAN THE ORIGINAL PROJECT OR THE PURPOSE ORIGINALLY INTENDED, WITHOUT THE WRITTEN PERMISSION OF DEBLASIO & ASSOCIATES, P.C. IS PROHIBITED.



# WILDWOOD CREST FISHING PIER REPLACEMENT AND EXPANSION (WATER FRONT DEVELOPMENT PERMIT)

UTILITIES	
<b>PUBLIC WORKS:</b>	WILDWOOD CREST PUBLIC WORKS DEPARTMENT STEVE SHEARER 120 W. NEWARK AVENUE WILDWOOD CREST, NJ 08260 609-522-7446
<b>SEWER:</b>	WILDWOOD CREST SEWER DEPARTMENT STEVE SHEARER 120 W. NEWARK AVENUE WILDWOOD CREST, NJ 08260 609-522-7446 CAPE MAY COUNTY M.U.A. THOMAS J. LAROCCO, P.E. 1523 ROUTE 9 NORTH, PO BOX 6110 CAPE MAY COURT HOUSE, NJ 08210 609-465-9026
<b>WATER:</b>	WILDWOOD WATER UTILITY KEITH LAMB 3416 PARK BOULEVARD WILDWOOD, NJ 08260 609-546-0600
<b>ELECTRIC:</b>	ATLANTIC CITY ELECTRIC COMPANY GREG DOMSIC 420 ROUTE 9 NORTH CAPE MAY COURT HOUSE, NJ 08210 609-463-3816
<b>CABLE:</b>	COMCAST CABLE TONY VOROS 1846 NW BOULEVARD VINELAND, NJ 08360 800-934-6489
<b>GAS:</b>	SOUTH JERSEY GAS COMPANY JEREMAH LIN 1708 ROUTE 9 NORTH CAPE MAY COURT HOUSE, NJ 08210 609-465-2900
<b>TELEPHONE:</b>	VERIZON ENGINEERING DEPARTMENT STEPHANIE WEBSTER 10 TANSBORO ROAD, FLOOR 2 BERLIN, NJ 08009 732-357-3021
<b>COUNTY ROADS:</b>	CAPE MAY COUNTY PUBLIC WORKS ROBERT CHURCH, P.E. 4 MOORE ROAD CAPE MAY COURT HOUSE, NJ 08210 609-465-1035

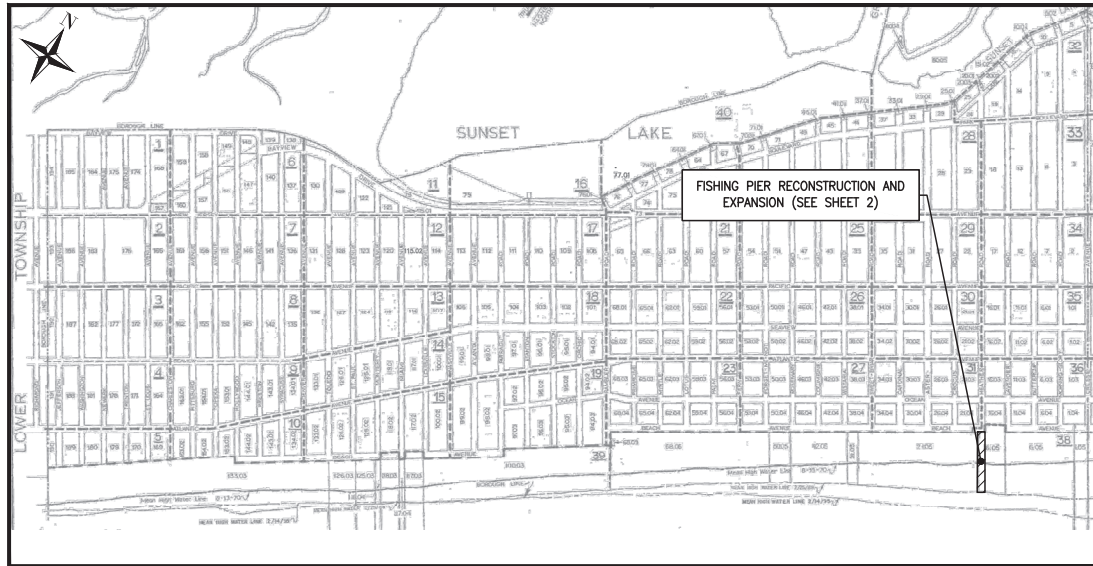

PROJECT LOCATION MAP



## BOROUGH OF WILDWOOD CREST CAPE MAY COUNTY, NEW JERSEY

INDEX OF SHEETS	
SHEET NO.	DESCRIPTION
1	TITLE SHEET (WFD PERMIT)
2	FISHING PIER REPLACEMENT & EXPANSION (WFD PERMIT)
3-4	CONSTRUCTION DETAILS (WFD PERMIT)

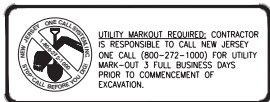
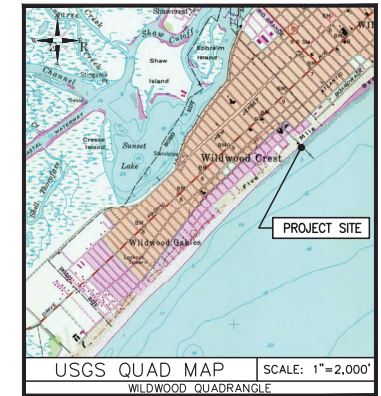

ISSUED FOR  
PERMITTING

NO.	DATE	APPR.	REVISION

**TITLE SHEET (WFD PERMIT)**

**DeBlasio & Associates**  
CONSULTING ENGINEERS AND PLANNERS

4701 NEW JERSEY AVENUE  
WILDWOOD, NJ 08260  
PHONE: (609) 854-1311  
FAX: (609) 854-4323  
WWW.DEBLASIOANDASSOCIATES.COM  
Certification of Authorization No. 24CA2084900

WILDWOOD CREST FISHING PIER REPLACEMENT AND EXPANSION  
BOROUGH OF WILDWOOD CREST  
CAPE MAY COUNTY, NEW JERSEY

Utmost: JLM    Drawn: MCA    Check: MAD    Date: 6/25/25

MARC A. DEBLASIO, PE    DATE  
New Jersey License No. 41599

Scale: AS SHOWN    Date: 6/25/25

2019 N.J.D.O.T. STANDARD SPECIFICATIONS FOR ROADWAY AND BRIDGE CONSTRUCTION SHALL GOVERN, EXCEPT FOR THOSE DETAILS CONTAINED HEREIN

COPYRIGHT 2025, DEBLASIO & ASSOCIATES, P.C. - ALL RIGHTS RESERVED. THE COPYING OR REUSE OF THIS DOCUMENT OR PORTIONS THEREOF, FOR OTHER THAN THE ORIGINAL PROJECT OR THE PURPOSE ORIGINALLY INTENDED, WITHOUT THE WRITTEN PERMISSION OF DEBLASIO & ASSOCIATES, P.C. IS PROHIBITED.

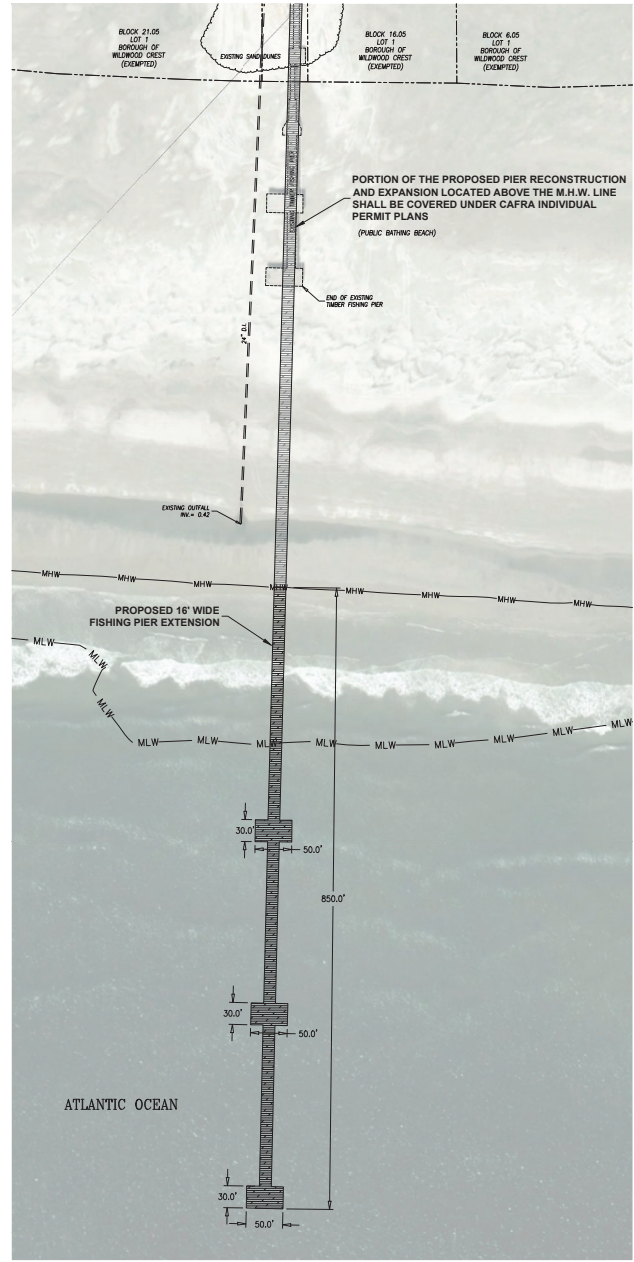
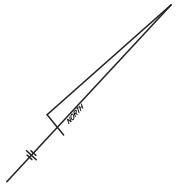

**PLAN**  
SCALE : 1"=80'

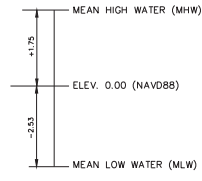

**NOTES:**  
1. TIDAL INFORMATION WAS TAKEN FROM NOAA VDATUM VERSION 4.6.1 (NAVO 88).

**TIDAL REFERENCE**  
N.T.S.

- NOTES:**
- EXISTING TOPOGRAPHIC INFORMATION SHOWN WAS BASED ON A FIELD SURVEY COMPLETED ON 06/19/2025 UNDER THE SUPERVISION OF HENRY V. ENGEL, N.J.P.L.S. LICENSE NO. 35833.
  - ELEVATIONS SHOWN ARE BASED ON NAVD88 DATUM.
  - HORIZONTAL CONTROL IS REFERENCED TO THE NEW JERSEY STATE PLANE COORDINATE SYSTEM (NAD 1983).
  - PROPERTY AND RIGHT-OF-WAY LINES SHOWN ARE APPROXIMATE LOCATIONS BASED ON THE CURRENT TAX MAPS OF THE BOROUGH OF WILDWOOD CREST, CAPE MAY COUNTY, NEW JERSEY. SAID LINES ARE SHOWN FOR GRAPHICAL INFORMATION ONLY AND HAVE NOT BEEN FIELD VERIFIED.
  - DIGITAL ORTHOPHOTOGRAPHY SHOWN PROVIDED BY THE NJ OFFICE OF INFORMATION TECHNOLOGY (NJ.OIT), OFFICE OF GEOGRAPHIC INFORMATION SYSTEMS (OGIS), DATED 2015.

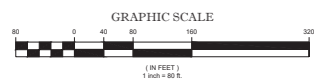
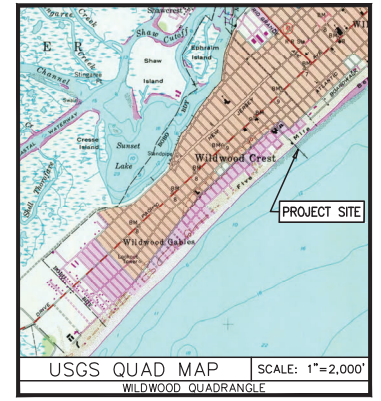

**ISSUED FOR PERMITTING**

NO.	DATE	APPR.	REVISION

COPYRIGHT 2025, DEBLASIO & ASSOCIATES, P.C. - ALL RIGHTS RESERVED. THE COPYING OR REUSE OF THIS DOCUMENT OR PORTIONS THEREOF, FOR OTHER THAN THE ORIGINAL PROJECT OR THE PURPOSE ORIGINALLY INTENDED, WITHOUT THE WRITTEN PERMISSION OF DEBLASIO & ASSOCIATES, P.C. IS PROHIBITED.

Drawn: JLM	Checked: MCA	Scale: 1/8"=1'-0"	Date: 6/25/25
<b>MARC A. DEBLASIO, PE</b> DATE New Jersey License No. 41599 Scale: AS NOTED      Date: 6/25/25			

**FISHING PIER REPLACEMENT & EXPANSION (WFD PERMIT)**

**DEBLASIO & ASSOCIATES**  
CONSULTING ENGINEERS AND PLANNERS

4701 NEW JERSEY AVENUE  
WILDWOOD, NJ 08260  
PHONE (609) 854-3311  
FAX (609) 854-4323  
WWW.DEBLASIOASSOCI.COM  
Certification of Authorization No. 24CA20284900

WILDWOOD CREST FISHING PIER REPLACEMENT AND EXPANSION  
BOROUGH OF WILDWOOD CREST  
CAPE MAY COUNTY, NEW JERSEY

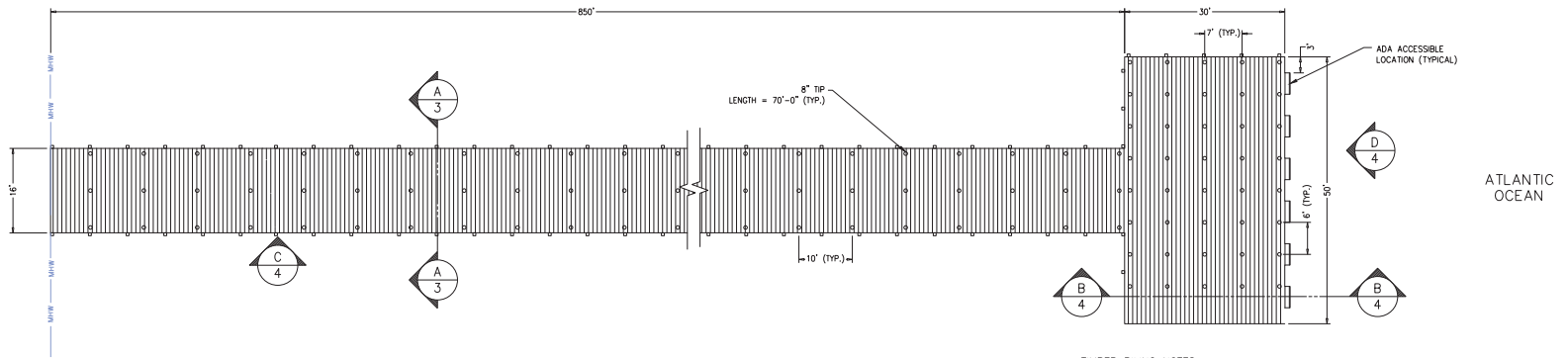

FISHING PIER STRUCTURE

SCALE: N.T.S.

TIMBER PILING NOTES:

- A) PILING SHALL BE 8 INCH MINIMUM TIP DIAMETER NATURAL TAPER CONFORMING TO ASTM D25 CERTIFIED GREENHEART (CHLOROACRIDUM RODIC). PILES SHALL BE NEW AND FREE FROM ANY SPLITS, CHECKS, OR DEFORMATIONS WHICH REDUCE STRUCTURAL LOAD CARRYING CAPACITY. TIMBER PILES SHALL NOT BE SPLICED.
- B) PILES SHALL BE DRIVEN WITH A HAMMER DELIVERING A MINIMUM RATED ENERGY BETWEEN 8,000 AND 15,000 FT-LB. CONTRACTOR SHALL SUBMIT PROPOSED PILE DRIVING HAMMER EQUIPMENT INFORMATION AND WAVE EQUATION ANALYSIS FOR APPROVAL PRIOR TO STARTING WORK. PILES SHALL BE DRIVEN TO 8 TON CAPACITY AS VERIFIED BY ENGINEERING NEW RECORD FORMULA. ALL INSTALLED PILES SHALL BE CERTIFIED FOR CAPACITY BY A NJ LICENSED PROFESSIONAL ENGINEER.
- C) TWO 50 FT. TEST PILES SHALL BE DRIVEN BY THE CONTRACTOR AND WITNESSED BY THE ENGINEER PRIOR TO ORDERING PRODUCTION PILES. PILE ORDER LENGTH SHALL DEPEND ON THE TEST DRIVE BY THE CONTRACTOR. ALL PILES SHALL BE DRIVEN TO A MINIMUM TIP ELEVATION AND TERMINAL DRIVING RESISTANCE. MIN. TIP SHALL BE AS SHOWN (MIN. DATUM). TERMINAL DRIVING RESISTANCE SHALL BE AS SPECIFIED BY THE CERTIFYING ENGINEER AND BASED UPON THE CONTRACTOR'S DRIVING EQUIPMENT SUBMITTAL. THE CERTIFYING ENGINEER SHALL MAKE THE FINAL DETERMINATION OF FINAL PILE LENGTH, DRIVING CRITERIA, AND MAXIMUM STRUCTURAL CAPACITY.
- D) PILES MAY BE INSTALLED BY SPUDDING OR JETTING WITH APPROVAL OF THE DESIGN ENGINEER. PRE-ANNEERING SHALL BE PERMITTED TO 10 FT. BELOW GRADE. ALL PILES SHALL BE DRIVEN FROM 10 FT. BELOW GRADE TO THE MINIMUM TIP ELEVATION, THEN DRIVE PILES UNTIL CERTIFYING ENGINEER SPECIFIED TERMINAL RESISTANCE (BLOW COUNT) IS ACHIEVED OVER A DISTANCE OF 1 FOOT. PILES NOT MEETING THE DRIVE CRITERIA SHALL REST 24 - 48 HOURS BEFORE RESTRIKING. AFTER RESTRIKING, IF PILE STILL DOES NOT MEET DRIVE CRITERIA, SUSPEND DRIVING OPERATIONS AND CONTACT DESIGN ENGINEER.
- E) PILE CENTERLINES SHALL BE LOCATED WITHIN 3 INCHES OF PLAN DIMENSIONS AT THE CUT-OFF ELEVATION AS SHOWN ON THE DRAWINGS. PILE SHALL BE PLUMB AND NO GREATER THAN 1 INCH IN 10 FEET FROM THE VERTICAL WITH A MAXIMUM OF 4 INCHES OVER THE ENTIRE LENGTH OF THE PILE. FINAL PILE CUT-OFFS SHALL BE PERPENDICULAR TO THE PILE AXIS AND AS SHOWN ON THE DRAWINGS.
- F) HEAVED PILES SHALL BE RE-DRIVEN TO THE MINIMUM TIP ELEVATION AND SPECIFIED TERMINAL DRIVING RESISTANCE. MISALIGNED, DAMAGED, SPLIT OR OTHER PILING NOT MEETING THE SPECIFICATIONS HEREIN, SHALL BE REMOVED AND REPLACED AT THE CONTRACTORS EXPENSE.

DESIGN CRITERIA:

- A) NEW JERSEY UNIFORM CONSTRUCTION CODE N.J.A.C. 5:23 ET. SEQ.
- B) AMERICAN SOCIETY OF CIVIL ENGINEERS STANDARD ASCE/SEI 7-10 "MINIMUM DESIGN LOADS FOR BUILDINGS AND OTHER STRUCTURES".
- C) AMERICAN SOCIETY OF CIVIL ENGINEERS STANDARD ASCE/SEI 24-14 "FLOOD RESISTANT DESIGN AND CONSTRUCTION".
- D) LOADS (GRAVITY)
- E) WIND LOADING  
 EXTERIOR DECK LL = 100PSF  
 BASIC WIND SPEED (3-SECOND GUST) = 120 MPH  
 OCCUPANCY CATEGORY = II IMPORTANCE FACTOR = 1.00  
 EXPOSURE CATEGORY = D

WOOD FRAMING

1. PROVIDE ALL WOOD FRAMING MATERIALS SHOWN ON THE PLANS FOR COMPLETE CONSTRUCTION.
2. ALL WOOD FRAMING AND RAILING SHALL BE GREENHEART WOOD MATERIAL.
3. ALL EXPOSED CORNER EDGES ON TOP AND SIDE HANDRAILS TO BE ROUTED AND SANDED TO PROVIDE A SMOOTH FINISH.
4. ALL WOOD DECKING SHALL BE CUMARU (DIPTERYX ODORATA) (Fb = 10,975 PSI).
5. SPACING BETWEEN DECKING SHALL NOT EXCEED 1/2".
6. NO OPENINGS SHALL BE MADE IN ANY STRUCTURAL MEMBER UNLESS SPECIFICALLY SHOWN ON THE STRUCTURAL DRAWING OR OTHER APPROVAL FROM THE ENGINEER.
7. ALL STAINLESS STEEL BOLTS, NUTS, WASHERS, THREADS, AND RODS SHALL BE ASTM A 276 GRADE 316.

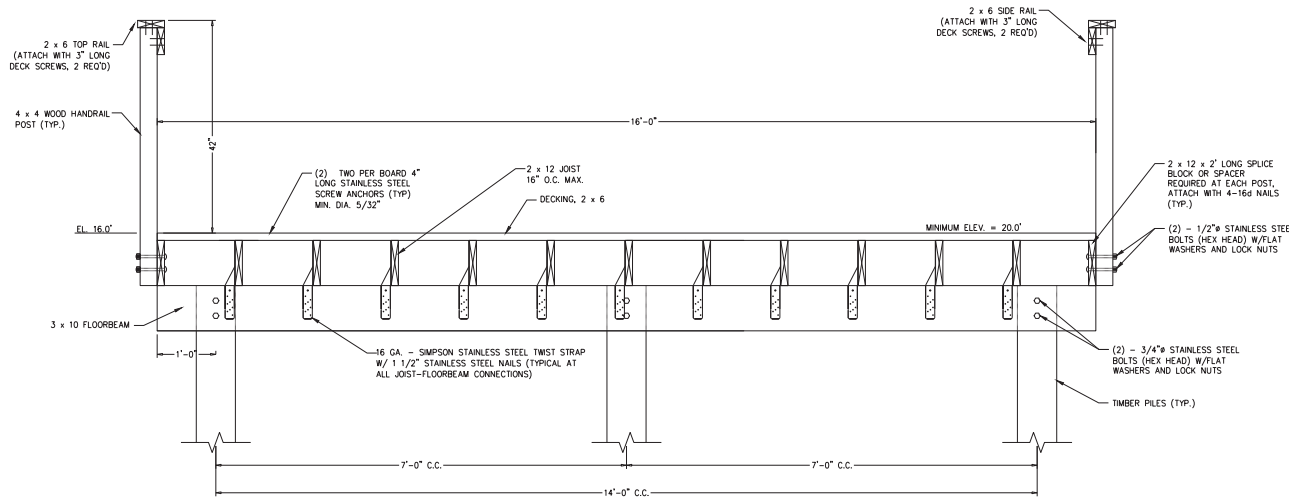

TIMBER FISHING PIER  
(SECTION A-A)

SCALE: 1" = 1'-0"

CONSTRUCTION  
DETAILS (WFD PERMIT)

**DeBlasio & Associates**  
CONSULTING ENGINEERS AND PLANNERS  
4701 NEW JERSEY AVENUE  
WILDWOOD, NJ 08260  
PHONE (609) 654-1311  
FAX (609) 654-4322  
WWW.DEBLASIOASSOC.COM  
Certification of Authorization No. 242428284900

ISSUED FOR  
PERMITTING

WILDWOOD CREST FISHING PIER  
REPLACEMENT AND EXPANSION  
BOROUGH OF WILDWOOD CREST  
CAPE MAY COUNTY, NEW JERSEY

Version:	Drawn:	Check:	Date:
JLM	MCA	MAD	6/25/25

NO.	DATE	APPROV.	REVISION

COPYRIGHT 2025, DEBLASIO & ASSOCIATES, P.C. - ALL RIGHTS RESERVED. THE COPYING OR REUSE OF THIS DOCUMENT OR PORTIONS THEREOF, FOR OTHER THAN THE ORIGINAL PROJECT OR THE PURPOSE ORIGINALLY INTENDED, WITHOUT THE WRITTEN PERMISSION OF DEBLASIO & ASSOCIATES, P.C. IS PROHIBITED.

MARC A. DEBLASIO, PE DATE  
New Jersey License No. 41599  
Scale: AS NOTED  
Date: 6/25/25



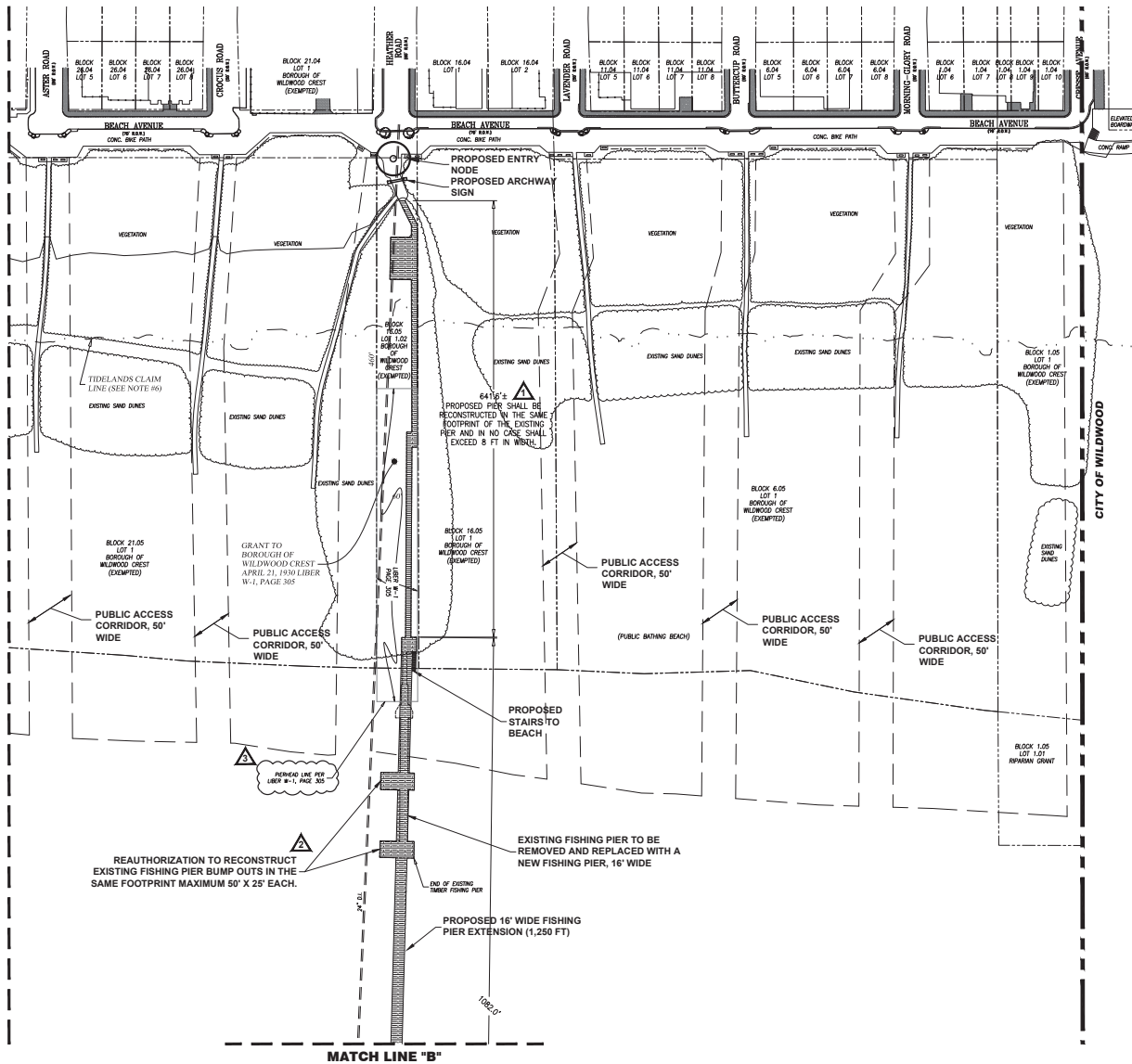

**PLAN**  
SCALE : 1"=80'

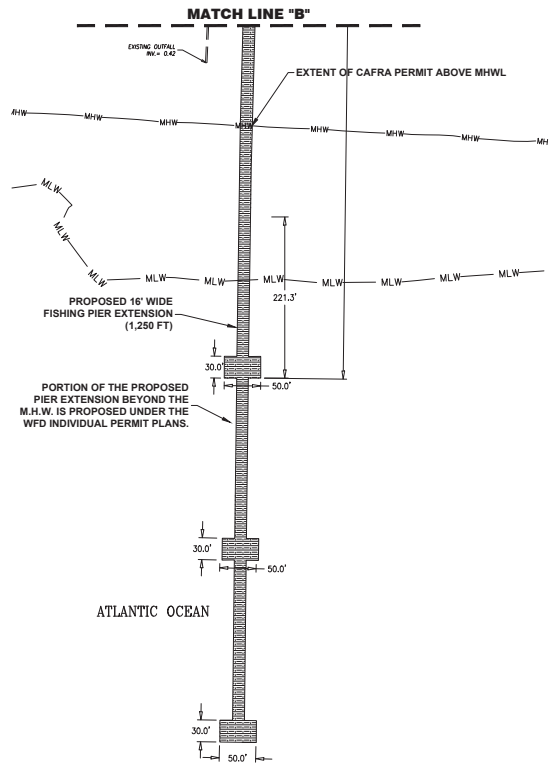

- NOTES:**
- EXISTING TOPOGRAPHIC INFORMATION SHOWN WAS BASED ON A FIELD SURVEY COMPLETED ON 06/19/2025 UNDER THE SUPERVISION OF HENRY V. ENGEL, N.J.P.L.S. LICENSE NO. 35833.
  - ELEVATIONS SHOWN ARE BASED ON NAVD88 DATUM.
  - HORIZONTAL CONTROL IS REFERENCED TO THE NEW JERSEY STATE PLANE COORDINATE SYSTEM (NAD 1983).
  - PROPERTY AND RIGHT-OF-WAY LINES SHOWN ARE APPROXIMATE LOCATIONS BASED ON THE CURRENT TAX MAPS OF THE BOROUGH OF WILDWOOD CREST, CAPE MAY COUNTY, NEW JERSEY. SAID LINES ARE SHOWN FOR GRAPHICAL INFORMATION ONLY AND HAVE NOT BEEN FIELD VERIFIED.
  - DIGITAL ORTHOPHOTOGRAPHY SHOWN PROVIDED BY THE NJ OFFICE OF INFORMATION TECHNOLOGY (NOIT), OFFICE OF GEOGRAPHIC INFORMATION SYSTEMS (OGIS), DATED 2015.
  - TIDELANDS CLAIM LINE WAS OBTAINED FROM NEW JERSEY DEPARTMENT OF ENVIRONMENTAL PROTECTION GEOGRAPHIC INFORMATION SYSTEM DIGITAL DATA.

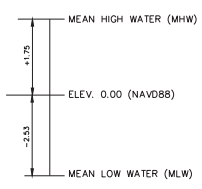

**NOTES:**  
1. TIDAL INFORMATION WAS TAKEN FROM NOAA DATUM VERSION 4.6.1 (NAVD 88).  
**TIDAL REFERENCE**  
N.T.S.

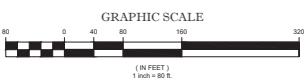
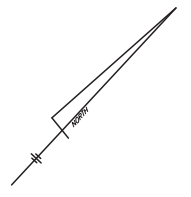

**FISHING PIER REPLACEMENT & EXPANSION (CAFRA PERMIT)**

**DEBLASIO & ASSOCIATES**  
ENGINEERS, SURVEYORS AND PLANNERS

4701 NEW JERSEY AVENUE  
WILDWOOD, NJ 08260  
PHONE (609) 654-3311  
FAX (609) 654-4322  
WWW.DEBLASIOASSOC.COM  
Certification of Authorization No. 242428284900

**WILDWOOD CREST FISHING PIER REPLACEMENT AND EXPANSION BOROUGH OF WILDWOOD CREST CAPE MAY COUNTY, NEW JERSEY**

ISSUED FOR PERMITTING

NO. 241699  
DATE 2/26/2026  
MARC A. DEBLASIO, PE  
New Jersey License No. 41599

1	12.15.25	JUN	REVISED PIER WIDTH IN DUNES PER CORRESPONDENCE RECEIVED 12.3.2025
2	2.26.26	JUN	RE-AUTHORIZE FOOTPRINT OF EXISTING PIER BUMP OUTS
3	3.26.26	JUN	ADDED LAYER W-1 GRANT AREA
DESIGNER			
CHECKER			
DATE			REASON

COPYRIGHT 2026, DEBLASIO & ASSOCIATES, P.C. - ALL RIGHTS RESERVED. THE COPYING OR REUSE OF THIS DOCUMENT OR PORTIONS THEREOF, FOR OTHER THAN THE ORIGINAL PROJECT OR THE PURPOSE ORIGINALLY INTENDED, WITHOUT THE WRITTEN PERMISSION OF DEBLASIO & ASSOCIATES, P.C. IS PROHIBITED.