



**US Army Corps
of Engineers**
Philadelphia District

Wanamaker Building
100 Penn Square East
Philadelphia, PA 19107-3390
ATTN: CENAP-OP-R

Public Notice

Public Notice No.
CENAP-OPR-2021-00650-46

Date January 20, 2022

Application No.

File No.

In Reply Refer to:
REGULATORY BRANCH

This District has received an application for a Department of the Army permit pursuant to Section 10 of the Rivers and Harbors Act of 1899 (33 U.S.C. 403) .

The purpose of this notice is to solicit comments and recommendations from the public concerning issuance of a Department of the Army permit for the work described below.

APPLICANT: Brigantine Marina and Paddle Club

CONTACT: Waters Edge, Environmental, LLC

WATERWAY: Main Channel

LOCATION: 4401 Atlantic-Brigantine Boulevard, Lots 7, 7.01, 7.02, 8, and 9, Block 5702, City of Brigantine, Atlantic County, New Jersey

ACTIVITY: The applicant proposes to perform the following activities.

A) Mechanical Dredging : The applicant would perform maintenance and new dredging dredging of approximately 1,461 cubic yards of material to a depth of -3.00' mean low water datum. Material would be placed on hopper barges and then transferred to trucks to be transported to the disposal site. The area to be dredged would be approximately 25,234 S.F. (0.58 acres - 0.23 acre maintenance dredging and 0.35 acre new dredging). A silt curtain would be deployed around the excavator and hopper barge at all times during dredging. Material would be disposed on uplands at Surran's Soil Replenishment, LLC, in Corbin City, Atlantic County, NJ. The dredged material would consist of approximately 67.5% silts/clay and 28.4% sand.

B) Bulkhead Reconstruction with Boardwalk Construction: Approximately 104 linear feet of sheetpile bulkhead would be reconstructed in place of the existing timber bulkhead with an adjacent boardwalk. The bulkhead would be constructed of 146 fiberglass sheet piles, each 20 feet in length, using vibratory hammer method with "soft start". No discharge of backfill would be required. A public access boardwalk made from "alternative" materials would be constructed along the bulkhead, as well.

C) Pier Reconstruction: Existing piers would be reconstructed of "alternative" materials to accommodate 62 boat slips and 26 personal water craft slips for a total of 88 slips. The project

would include the placement of 136 new timber piles using vibratory hammer method with "soft start".

Historically, the site was authorized for dredging by this office under individual Department of the Army permit CENAP-OP-R-197800392 (expired 12/31/88).

The applicant has stated that A) they request a 10-year dredging allowance, B) no over-dredging is proposed, and C) no other work is proposed than what is described above for the completion of the project.

PURPOSE: The applicant's stated purposes for the work are as follows:

Dredging: The proposed dredging of the docks and mooring areas within the marina is necessary for the purpose of providing sufficient water depths for the mooring of pleasure crafts associated with the marina.

Docking: The proposed docking facility is for access to Main Channel including the mooring of pleasure vessels at the marina.

Bulkhead/Boardwalk: The proposed bulkhead replacement and associated boardwalk are to be constructed in order to maintain upland fill and prevent the leaching of sediment from the upland into the waterway as well as to provide public access to Main Channel.

The decision whether to issue a permit will be based on an evaluation of the activity's probable impact including its cumulative impacts on the public interest. The decision will reflect the national concern for both protection and utilization of important resources. The benefits which reasonably may be expected to accrue from the work must be balanced against its reasonably foreseeable detriments. All factors which may be relevant to the work will be considered including the cumulative effects thereof; among those are conservation, economics, aesthetics, general environmental concerns, wetlands, cultural values, fish and wildlife values, flood hazards, flood plain values, land use, navigation, shore erosion and accretion, recreation, water supply and conservation, water quality, energy needs, safety, food and fiber production, mineral needs and welfare of the people. A Department of the Army permit will be granted unless the District Engineer determines that it would be contrary to the public interest.

The Corps of Engineers is soliciting comments from the public; Federal, State, and local agencies and officials; Indian Tribes; and other interested parties in order to consider and evaluate the impacts of this proposed activity. Any comments received will be considered by the Corps of Engineers to determine whether to issue, modify, condition or deny a permit for this proposal. To make this decision, comments are used to assess impacts on endangered species, historic properties, water quality, general environmental effects, and the other public interest factors listed above. Comments are used in the preparation of an Environmental Assessment and/or an Environmental Impact Statement pursuant to the National Environmental Policy Act. Comments are also used to determine the need for a public hearing and to determine the overall public interest of the proposed activity.

Comments on the proposed work should be submitted, in writing, within 30 days to the District Engineer, U.S. Army Corps of Engineers (ACOE), Philadelphia District, Wanamaker Building, 100 Penn Square East, Philadelphia, Pennsylvania 19107-3390.

A preliminary review of this application indicates that the proposed work may affect listed species pursuant to Section 7 of the Endangered Species Act (ESA) as amended. The ACOE will forward this notice to the US Fish and Wildlife Service and National Marine Fisheries Service with a request for technical assistance on whether any ESA listed species or their critical habitat maybe present in the area which would be affected by the proposed activity. The Philadelphia District will evaluate the potential effects of the proposed actions on ESA listed species or their critical habitat and will consult with National Marine Fisheries Service as appropriate. ESA Section 7 consultation will be concluded prior to the final decision on this permit application.

With regard to Section 106 of the National Historic Preservation Act, this office has determined that the project has no potential to cause an effect on historic properties based on the following: A) the permit area has been so extensively modified that little likelihood exists for the proposed project to impact a historic property and B) the proposed work and/or structures are of such limited nature and scope that little likelihood exists for the proposed project to impact a historic property. Review of the National Register of Historic Places indicates that no registered properties or properties listed as eligible for inclusion therein are located within the permit area of the work.

The Magnuson-Stevens Fishery Conservation and Management Act, as amended by the Sustainable Fisheries Act 1996 (Public Law 104-267), requires all Federal agencies to consult with the National Marine Fisheries Service on all actions, or proposed actions, permitted, funded, or undertaken by the agency that may adversely effect Essential Fish Habitat (EFH). No permit shall be issued until this office has completed coordination with the National Marine Fisheries Service.

In accordance with Section 307(c) of the Coastal Zone Management Act of 1972, applicants for Federal Licenses or Permits to conduct an activity affecting land or water uses in a State's coastal zone must provide certification that the activity complies with the State's Coastal Zone Management Program. The applicant has stated that the proposed activity complies with and will be conducted in a manner that is consistent with the approved State Coastal Zone Management (CZM) Programs of New Jersey. No permit will be issued until the State has concurred with the applicant's certification or has waived its right to do so. Comments concerning the impact of the proposed and/or existing activity on the State's coastal zone should be sent to this office, with a copy to the States' Offices of Coastal Zone Management. It should be noted that the State of New Jersey issued its concurrence on June 9, 2021.

Any person may request, in writing, to the District Engineer, within the comment period specified in this notice, that a public hearing be held to consider this application. Requests for a public hearing shall state in writing, with particularity, the reasons for holding a public hearing.

Additional information concerning this permit application may be obtained by calling 215-605-7029 or by e-mailing Mr. David Caplan of my office at David.J.Caplan@usace.army.mil.

FOR Todd A. Schaible
Chief, Regulatory Branch

FIGURE 1 - USGS MAP

Block 5702, Lots 7, 8 & 9
Brigantine City, Atlantic County, NJ



LEGEND:

 PROPERTY BOUNDARY

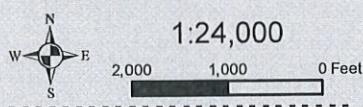

SOURCE DATA:

PROPERTY BOUNDARY:
Head-s-up digitizing based on Atlantic County
parcel data downloaded from NJGIS's
Information Warehouse

BASE SOURCEDATA:
USGS data downloaded from 2000 DeLorme,
3-D Topo Quads. (Quad. - Oceanville NJ)

*This map complies with the National Map Accuracy
Standards. This map was developed using New Jersey
Department of Environmental Protection Geographic
Information System digital data, but this secondary product
has not been verified by NJDEP and is not state-authorized.*

Water's Edge
Environmental, LLC

P.O. Box 118, Ocean City, NJ 08226

Phone: 609-249-3744

Fax: 609-249-3860

E-mail: mapstation@watersedgellc.com

Map Prepared by Zack Spatol

Map Created in July 2020

Project No. 1333

C:\USERS\TAYLOR\ONEDRIVE - SCIULLO ENGINEERING SERVICES, LLC(1)\LOUIS TAYLOR - SHARED\PROJECTS\SCA 01001 BAYSIDE MARINA, BRIGANTINE\DWG\REDGE PLAN\EO302-E0303.DWG
CREATED ON 06/22/2021, LAST MODIFIED ON 09/10/2021

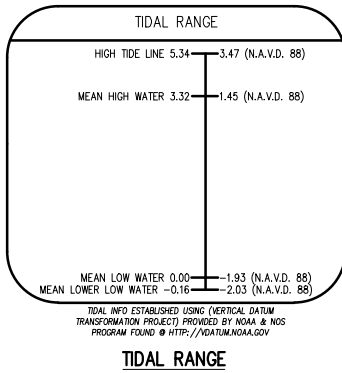

PROPOSED MAINTENANCE DREDGING

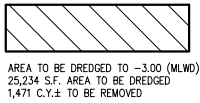

LEGEND

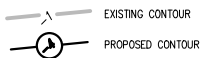

GRAPHIC SCALE

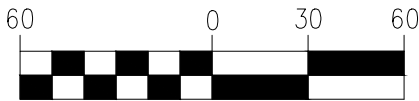

1 INCH = 60 FEET

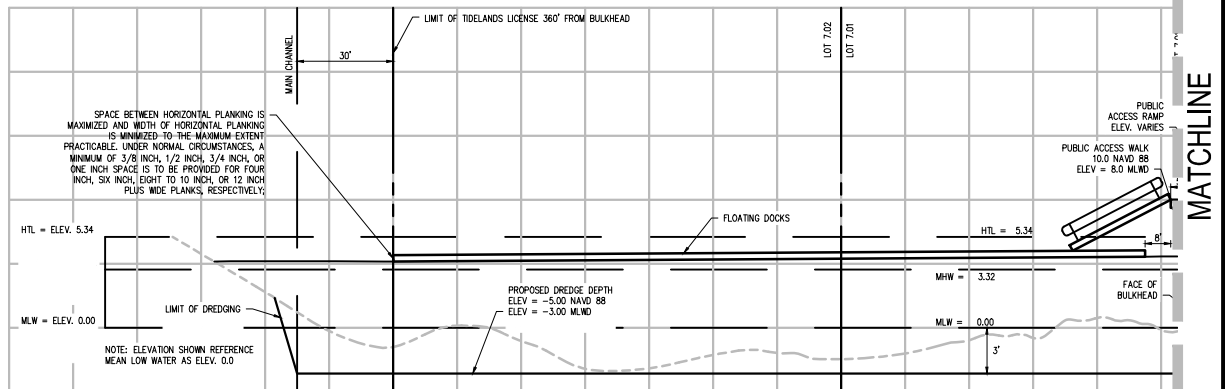
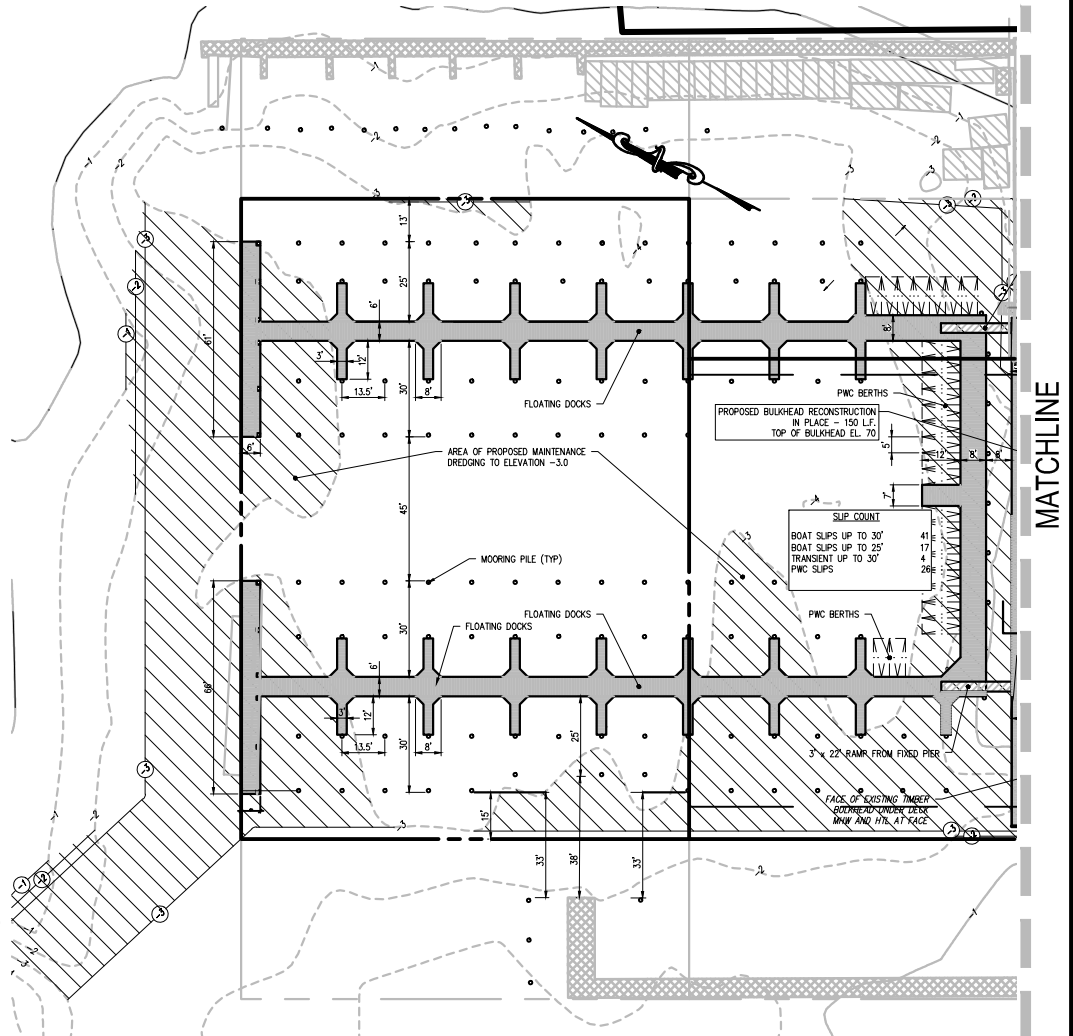

JASON T. SCIULLO, P.E., P.P.
PROFESSIONAL ENGINEER, NEW JERSEY LICENSE NO. 24GE04586000
PROFESSIONAL PLANNER, NEW JERSEY LICENSE NO. 33J00628400

jsciullo@sciulloengineering.com

DREDGE CROSS-SECTION A-A

E-2

HORIZONTAL SCALE: 1"=60'
VERTICAL SCALE: 1"=3'

SCA 010.01

17 South Gordon's Alley
Suite 3
Atlantic City
New Jersey 08401

SE SCIULLO
ENGINEERING SERVICES, LLC

ph (609) 300-5171

NJ CERTIFICATE OF AUTHORIZATION NO. 24GA28290700

BRIGANTINE MARINA & PADDLE CLUB
4401 ATLANTIC BRIGANTINE BLVD.; BLOCK 5702, LOTS 7-9 & 7.01
CITY OF BRIGANTINE, ATLANTIC COUNTY, NEW JERSEY

DATE:

9/13/2021

SCALE:

1" = 60'

E0302

C:\USERS\TAYLOR\ONE DRIVE - SCULLO ENGINEERING SERVICES, LLC\1\LOUIS TAYLOR - SHARED\PROJECTS\SCA 01001 BAYSIDE MARINA, BRIGANTINE\DWG\REDGE PLAN\E0303.DWG
CREATED ON 06/22/2021, LAST MODIFIED ON 09/10/2021

MATCHLINE

MATCHLINE

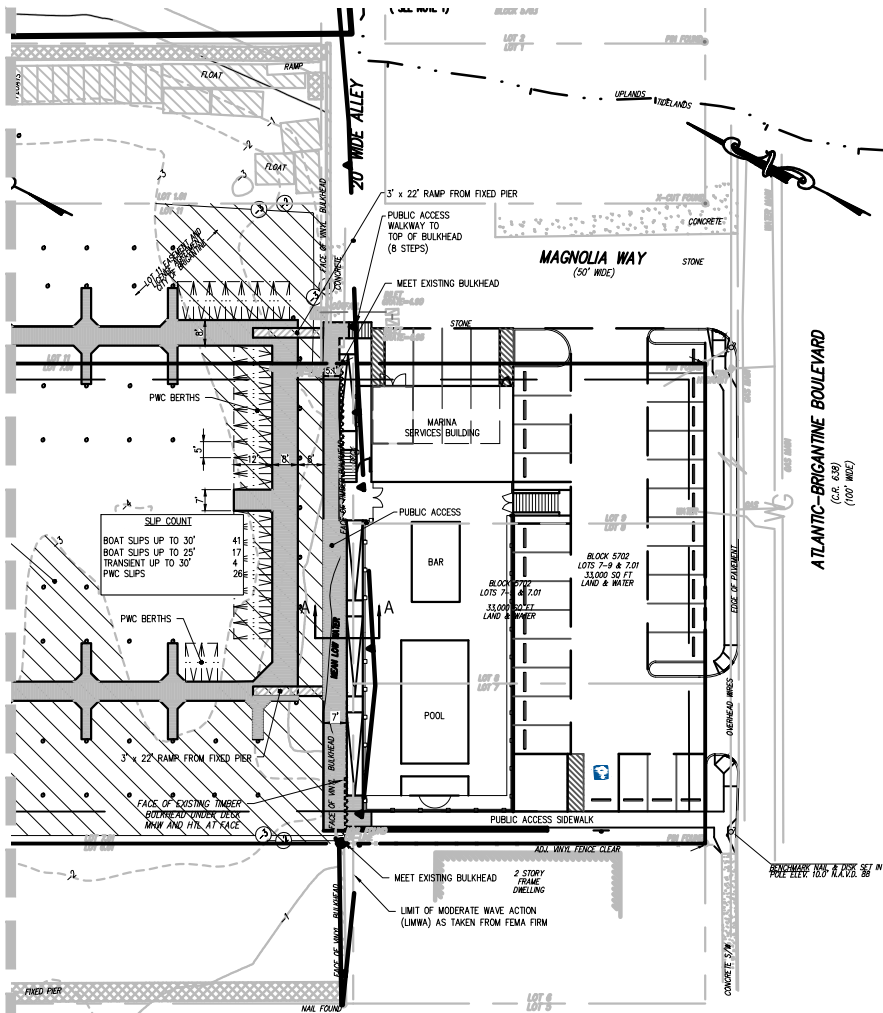

WATERFRONT DEVELOPMENT PERMIT PLAN

SCALE: 1"=60'

GRAPHIC SCALE

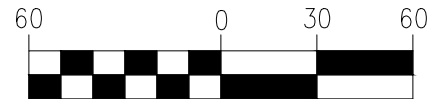

1 INCH = 60 FEET

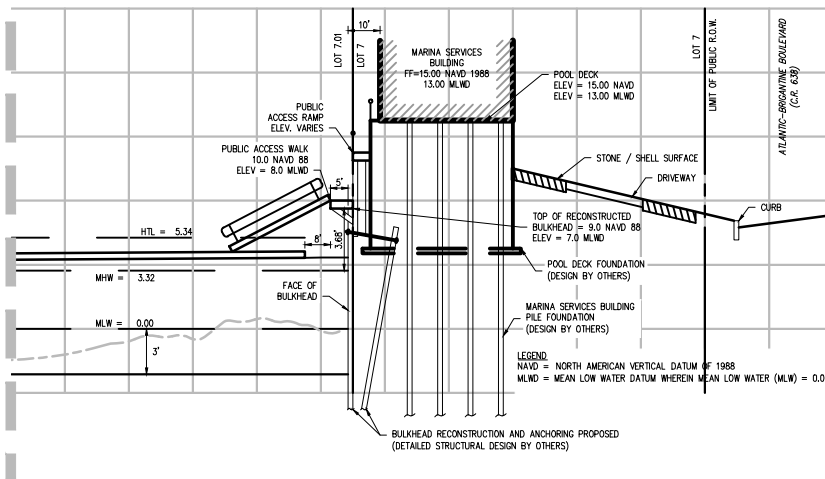

DREDGE CROSS-SECTION A-A

HORIZONTAL SCALE: 1"=60'

VERTICAL SCALE: 1"=3'

JASON T. SCIULLO, P.E., P.P.

PROFESSIONAL ENGINEER, NEW JERSEY LICENSE NO. 24GE04586000
PROFESSIONAL PLANNER, NEW JERSEY LICENSE NO. 33J00628400

jsciullo@sciulloengineering.com

E-3

SCA 010.01

17 South Gordon's Alley
Suite 3
Atlantic City
New Jersey 08401

SE

SCIULLO
ENGINEERING
SERVICES, LLC

ph (609) 300-5171

NJ CERTIFICATE OF AUTHORIZATION NO. 24GA28290700

BRIGANTINE MARINA & PADDLE CLUB

4401 ATLANTIC BRIGANTINE BLVD.; BLOCK 5702, LOTS 7-9 & 7.01
CITY OF BRIGANTINE, ATLANTIC COUNTY, NEW JERSEY

DATE:

9/13/2021

SCALE:

1" = 60'

E0303

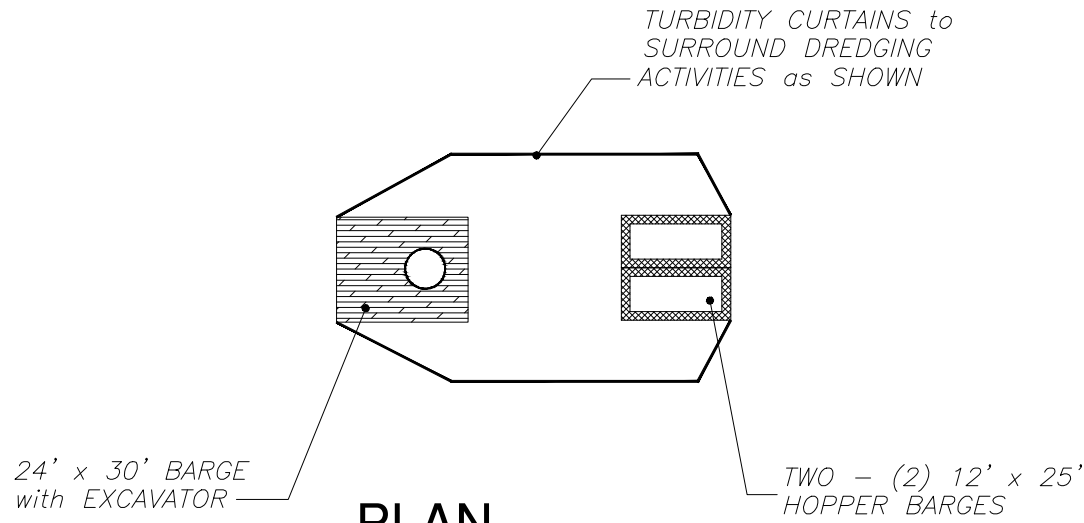

NOT to SCALE

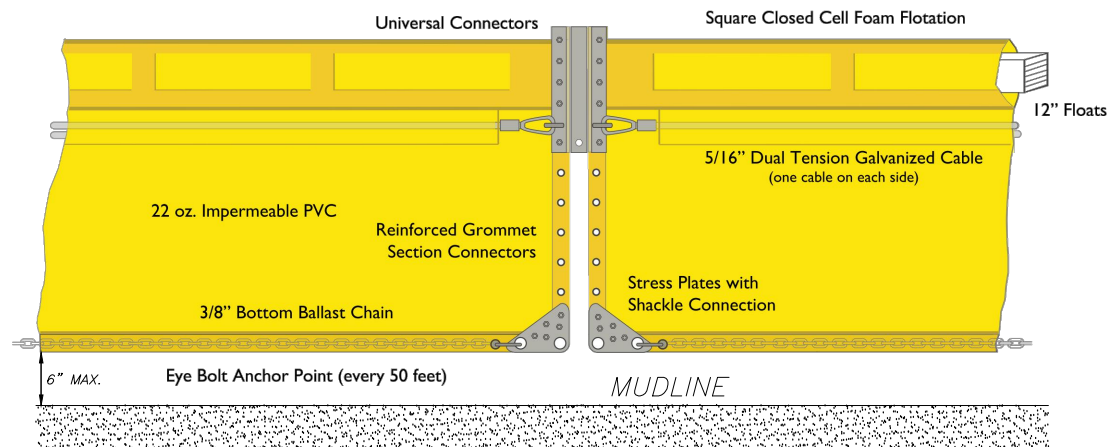

DETAIL

NOT to SCALE

E-4

TURBIDITY CURTAIN DETAIL SHEET

4401 ATLANTIC-BRIGANTINE BOULEVARD
LOTS 7, 7.01, 7.02, 8 and 9 in BLOCK 5702
CITY of BRIGANTINE
ATLANTIC COUNTY, NJ

APPLICANT: BRIGANTINE MARINA and PADDLE CLUB, LLC



P.O. BOX 118 OCEAN CITY, N.J. 08226
PHONE (609) 249-3744
EMAIL: info@watersedgellc.com

DWN BY: WE/JS

DATE: NOV. 3, 2021

DWG. NO. 1333-2021-2

SHT No. 1 of 1

Surran's Disposal Site

Block 301, Lot 17
Corbin City, Atlantic County, NJ

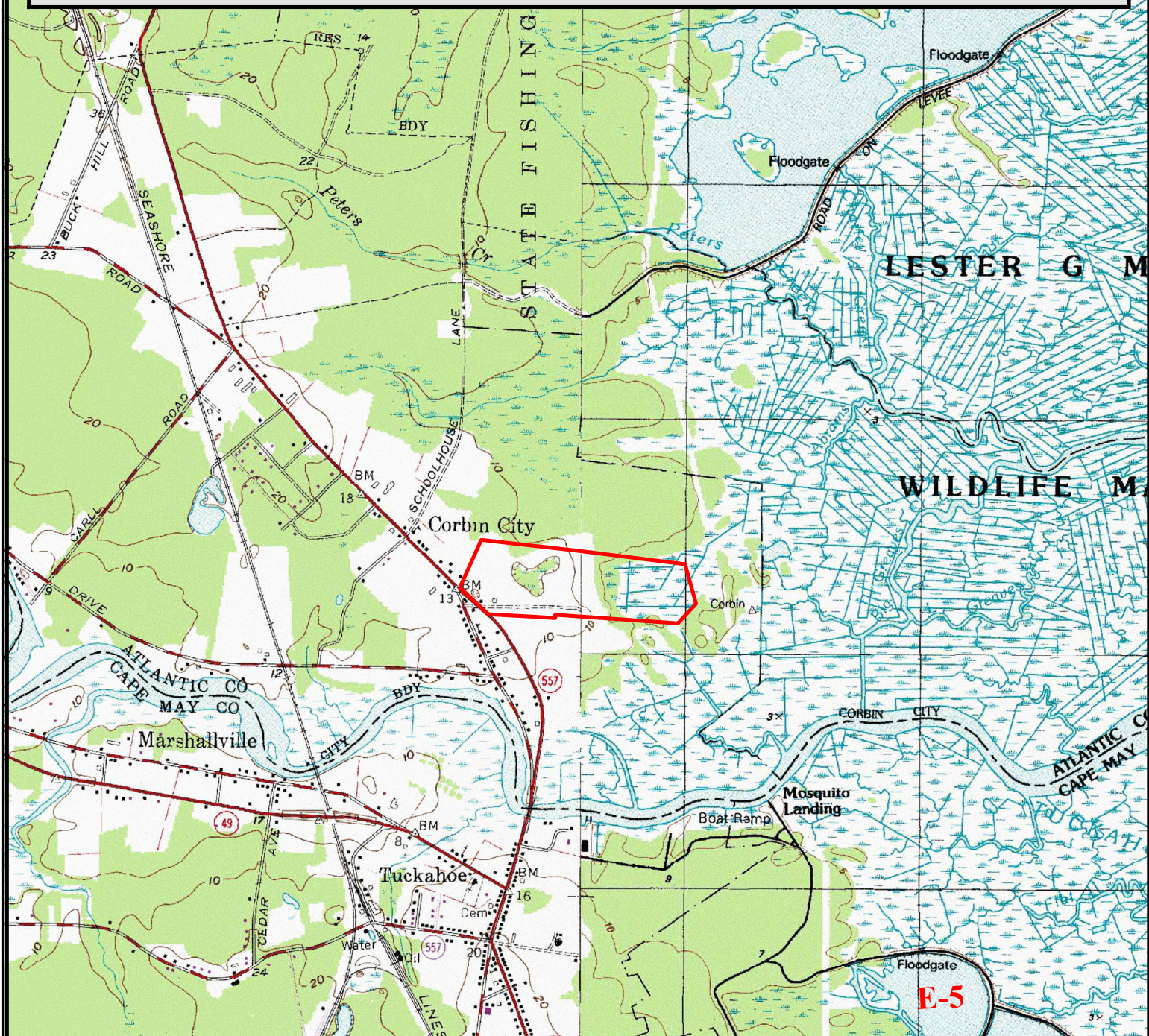

LEGEND:

 PROPERTY BOUNDARY



1:24,000

2,000 1,000 0 Feet

SOURCE DATA:

PROPERTY BOUNDARY:
Heads-up digitizing based on Atlantic County parcel data downloaded from NJGIN's Information Warehouse

BASE SOURCE DATA:
USGS data downloaded from 2000 DeLorme, 3-D Topo Quads. (Quad. - Tuckahoe & Marmora NJ)

This map complies with the National Map Accuracy Standards. This map was developed using New Jersey Department of Environmental Protection Geographic Information System digital data, but this secondary product has not been verified by NJDEP and is not state-authorized.

 **Water's Edge**
Environmental, LLC

P.O. Box 118, Ocean City, NJ 08226

Phone: 609-249-3744

Fax: 609-249-3860

E-mail: mapstation@watersedgellc.com

Map Prepared by Zack Spatol

Map Created in March 2020