



**US Army Corps  
of Engineers**  
Philadelphia District  
1650 Arch Street  
Philadelphia, PA 19103  
Attn: CENAP-OPR

# Public Notice

**Comment Period Begins:** June 30, 2023  
**Comment Period Ends:** July 30, 2023  
**File Number:** NAP-2022-00412-TEC  
**File Name:** GSP Operational Improvements, MP 80 to 83  
**Contact:** Adam Fannin  
**Email:** adam.e.fannin@usace.army.mil

---

This District has received an application for a Department of the Army permit pursuant to Section 10 of the Rivers and Harbors Act of 1899 (33 U.S.C. 403) and Section 404 of the Clean Water Act (33 U.S.C. 1344).

The purpose of this notice is to solicit comments and recommendations from the public concerning issuance of a Department of the Army permit for the work described below.

**APPLICANT:** New Jersey Turnpike Authority  
Michael Garofalo, Chief Engineer  
c/o Vincent Mignella, Project Engineer  
P.O. Box 5042  
Woodbridge, New Jersey 07095-5042  
mignella@njta.com

**AGENT:** Greenman-Pedersen, Inc. (GPI)  
Valerie Hrabal  
520 US 22, Suite 200  
Bridgewater, New Jersey, 08807  
vhrabal@gpinet.com

**LOCATION:** Garden State Parkway (Parkway) between Milepost 80.4 near the stream crossing of Jakes Branch and Milepost 84.1 near Interchange 83 at Route 9/166 crossing in Beachwood Borough, South Toms River Borough, Berkeley Township, and Toms River Township, Ocean County, New Jersey;  
Approximate Center Coordinates: 39.95002, -74.207783.

**PURPOSE:** The stated purpose of this project is to improve accessibility, safety, and travel time along the Parkway from Milepost 80 to 83 by constructing the missing Parkway access points at Interchange 80; providing additional traffic capacity and eliminating unsafe weaving conditions along the mainline and at interchanges; and correcting substandard design elements, where feasible.

## **PROJECT DESCRIPTION:**

The New Jersey Turnpike Authority (NJTA) has requested Department of the Army (DA) authorization to conduct work in navigable waters of the United States and to discharge dredged and/or fill material into waters of the United States associated with improvements to the Parkway between Milepost 80.4 near the stream crossing of Jakes Branch and Milepost 84.1 near Interchange 83 at Route 9/166 crossing. The proposed project would include widening the Parkway, resulting in mainly three through lanes with adjacent collector-distributor roadways in each direction-including safety and operational improvements at Interchanges 80, 81, and 82/82A.

Proposed improvements under this project would include improving Parkway geometrics to meet current NJTA design standards where feasible, creating continuous auxiliary lanes to better accommodate queuing and weaves; creating collector-distributor roads to physically separate local traffic from Parkway through traffic, safety and operational improvements of Parkway interchanges, ramps and adjoining State and local roadway networks, the addition of a new southbound entrance ramp and northbound exit ramp to Interchange 80. The proposed project would also result in the widening or replacement of seven (7) bridges, reconstruction and/or extension of several culvert pipes, replacement of guide rail, drainage system upgrades and overhead signing.

The application requested authorization for the temporary discharge of dredged and/or fill material into 0.024 acres of wetlands and for the permanent discharge of dredged and/or fill material into 1.143 acres of wetlands and 0.355 acres of tidal open waters to facilitate the construction of the proposed project.

For additional project details, see the attached plans identified as: New Jersey Turnpike Authority Garden State Parkway Preliminary Engineering and Environmental Permitting For Operational Improvements, Milepost 80 to 83, sheets 1-16, and dated May 2023.

## **MITIGATION**

The applicant has stated that the proposed project has been designed to avoid and minimize adverse effects on the aquatic environment to the maximum extent practicable. For unavoidable impacts to aquatic resources, the applicant has proposed compensatory mitigation.

The applicant has proposed to offset permanent unavoidable impacts to wetlands and tidal open waters via purchase of mitigation bank credits, while temporary impacted wetlands would be restored on-site. The applicant has indicated compensatory mitigation would comply with New Jersey Administrative Code 7:7A-11 and 7:7-17.

## **CORPS EVALUATION FACTORS**

The decision whether to issue a permit will be based on an evaluation of the activity's probable impact including its cumulative impacts on the public interest. The decision will reflect the national concern for both protection and utilization of important resources. The benefits which reasonably may be expected to accrue from the work must be balanced against its reasonably foreseeable detriments. All factors which may be relevant to the work will be considered including the cumulative effects thereof. Among these factors are conservation, economics, aesthetics, general environmental concerns, wetlands, cultural values, fish and wildlife values, flood hazards, flood plain values, land use, navigation, shore erosion and accretion, recreation, water supply and conservation, water quality, energy needs, safety, food and fiber production, mineral needs and welfare of the people.

The evaluation of the impact of this project will also include application of the Clean Water Act Section 404(b)(1) Guidelines promulgated by the Administrator, U.S. Environmental Protection Agency if the project includes a discharge of dredge or fill material pursuant to Section 404 of the Clean Water Act.

## **ENDANGERED SPECIES**

A preliminary review of this application indicates that species and/or their critical habitat pursuant to Section 7 of the Endangered Species Act (ESA) may be present in the action area. This office will forward this Public Notice to the U.S. Fish and Wildlife Service (USFWS) and/or National Marine Fisheries Service (NMFS) with a request for technical assistance on whether any ESA-listed species or their critical habitat may be present in the area which would be affected by the proposed activity. This office will evaluate the potential effects of the proposed actions on ESA-listed species or their critical habitat and will consult with the USFWS and/or NMFS, as appropriate. ESA Section 7 consultation would be concluded prior to the final decision on this permit application.

## **CULTURAL RESOURCES AND TRIBAL TRUST**

The District's Cultural Resource Specialist and Tribal Liaison is currently reviewing the proposed permit action for potential impacts to Historic Properties eligible for or listed on the National Register of Historic Places and for potential issues concerning the Tribes. The proposed permit action will be an Adverse Effect to the Garden State Parkway Historic District and may adversely affect other historic properties eligible for or listed on the National Register of historic places. Further investigations, consultation and analyses will be required throughout the Section 106 process.

## **ESSENTIAL FISH HABITAT**

The Magnuson-Stevens Fishery Conservation and Management Act (MSA) requires all federal agencies to consult with the National Marine Fisheries Service (NMFS) for all actions, or proposed actions, permitted, funded, or undertaken by the agency that may adversely affect Essential Fish Habitat (EFH). A preliminary review of this application

indicates that EFH is present within the project area. This office will evaluate the potential effects of the proposed actions on EFH and will consult with NMFS, as appropriate. Consultation would be concluded prior to the final decision on this permit application.

## **WATER QUALITY CERTIFICATE**

In accordance with Section 401 of the Clean Water Act, a Water Quality Certificate (WQC) is required from the State government in which the work is located. Any comments concerning the work described above which relate to Water Quality considerations should be sent to this office with a copy to the State.

## **COASTAL ZONE MANAGEMENT ACT**

In accordance with Section 307(c) of the Coastal Zone Management Act of 1972, applicants for Federal Licenses or Permits to conduct an activity affecting land or water uses in a State's coastal zone must provide certification that the activity complies with the State's Coastal Zone Management (CZM) Program. The applicant has stated that the proposed activity complies with and will be conducted in a manner that is consistent with the approved State CZM Program. No permit will be issued until the State has concurred with the applicant's certification or has waived its right to do so. Comments concerning the impact on the State's coastal zone should be sent to this office with a copy to the State's CZM office.

## **SUBMISSION OF COMMENTS AND PUBLIC HEARING REQUEST**

Any comments received will be considered by this office to determine whether to issue, modify, condition, or deny a permit for this proposed project. To make this decision, comments are used to assess the probable impact on the public interest. Comments are also used to determine the need for a public hearing and to determine the overall public interest of the proposed activity.

Comments on the proposed work must be submitted, in writing, within the comment period indicated in the header above. Any person may request, within the comment period specified in this notice, that a public hearing be held to consider this application. Requests for a public hearing must be in writing and state the reasons for holding a public hearing.

Please provide any comments, request for a public hearing, or requests for additional information to the Regulatory Project Manager indicated above. All Public Notices are posted on our website at:

<https://www.nap.usace.army.mil/Missions/Regulatory/Public-Notices/>

Todd A.  
Schaible  
Todd A. Schaible  
Chief, Regulatory Branch

Digitally signed by  
Todd A. Schaible  
Date: 2023.06.28  
16:41:21 -04'00'

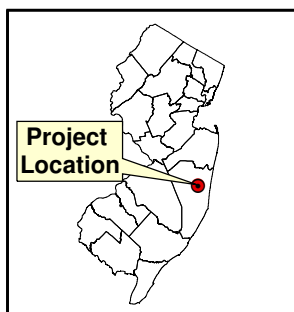
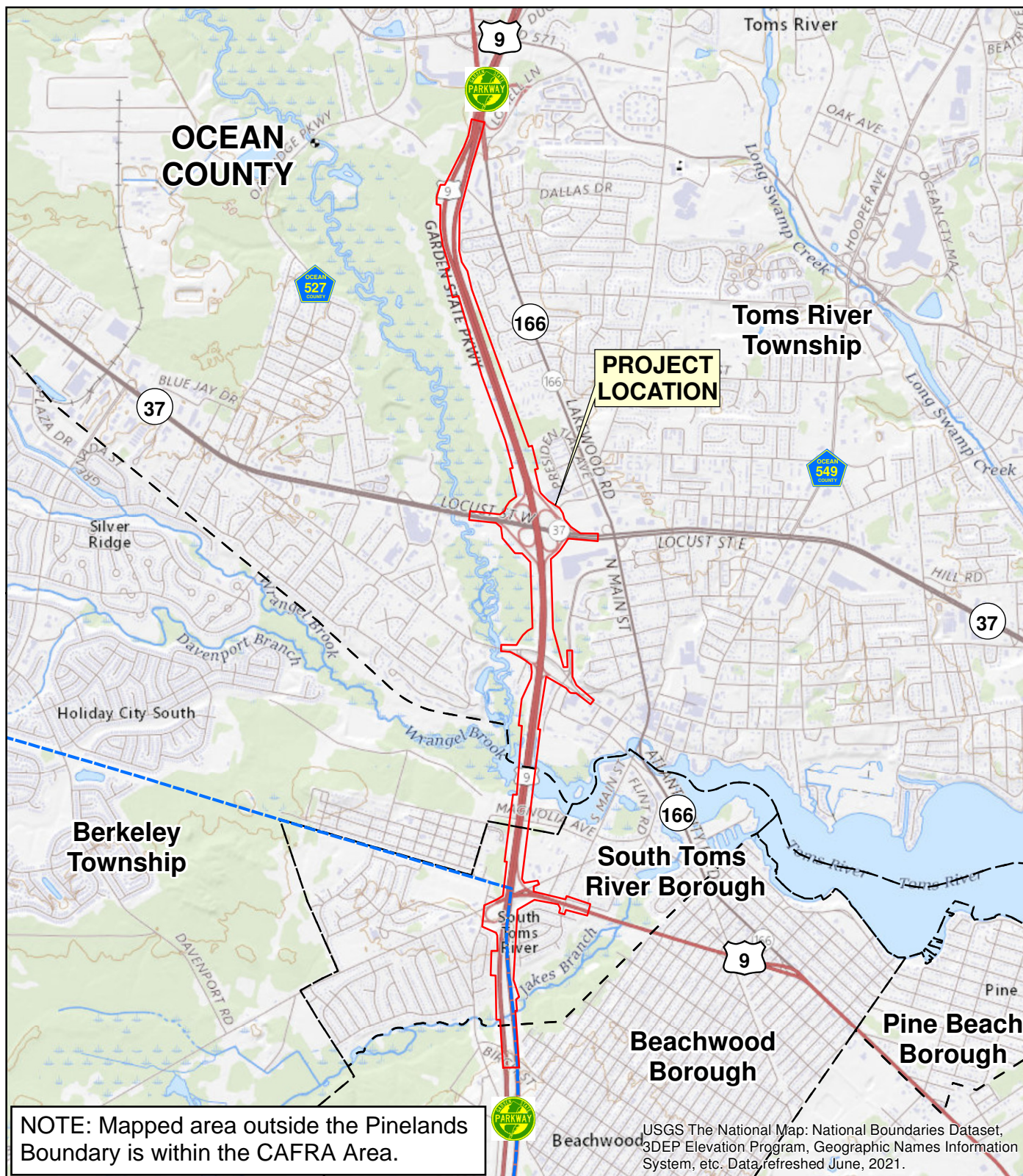
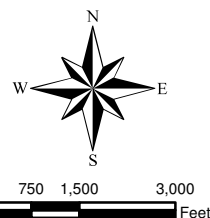

Figure 1: Project Location Map (USGS)

**Operational Improvements, Milepost 80-83**  
**Garden State Parkway**  
 Toms River and Berkeley Townships, and  
 South Toms River and Beachwood Boroughs  
 Ocean County, New Jersey

**Legend**

- Project Location
- Pinelands Boundary
- Municipality Boundary



**McCORMICK TAYLOR**

DIANE GUTIERREZ-SCACCEITI  
CHAIR

ULISES E. DIAZ  
VICE CHAIR

MICHAEL R. DU PONT  
TREASURER

RONALD GRAVINO  
COMMISSIONER

JOHN D. MINELLA  
COMMISSIONER

RAPHAEL SALERMO  
COMMISSIONER

## INDEX OF SHEETS

SUMMARY OF USACE WETLAND IMPACTS - PROJECT TOTALS				
PERM. WETLAND IMPACT	TEMP. WETLAND IMPACT	PERM. OPEN WATER IMPACT	TEMP. OPEN WATER IMPACT	TOTAL IMPACT
49,802 SF (1,143 AC)	1,025 SF (0,024 AC)	15,471 SF (0,355 AC)	0 SF (0 AC)	66,298 SF (1,522 AC)

SHEET NO.	DESCRIPTION
1	TITLE SHEET
2	GENERAL LEGEND
3 - 5	PLAN REFERENCE SHEETS
6 - 15	USACE JURSDICTIONAL PLANS
16	GENERAL PLAN AND ELEVATION BRIDGE NO. 81,4 OVER

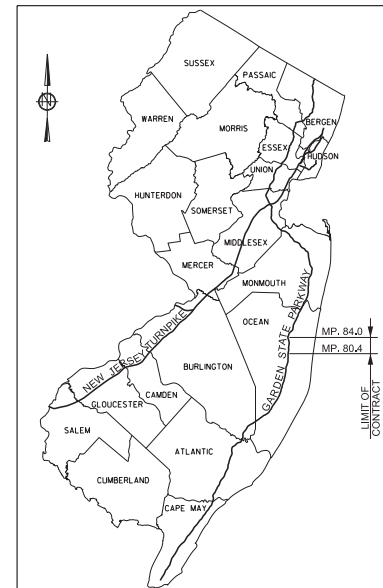

I CERTIFY UNDER PENALTY OF LAW THAT I HAVE PERSONALLY EXAMINED AND AM FAMILIAR WITH THE INFORMATION SUBMITTED IN THIS DOCUMENT AND ALL ATTACHMENTS AND THAT, BASED ON MY INQUIRY OF THOSE INDIVIDUALS IMMEDIATELY RESPONSIBLE FOR OBTAINING AND PREPARING THE INFORMATION, I BELIEVE THAT THE INFORMATION IS TRUE, ACCURATE, AND COMPLETE. I AM AWARE THAT THERE ARE SIGNIFICANT PENALTIES FOR KNOWINGLY SUBMITTING FALSE INFORMATION, INCLUDING THE POSSIBILITY OF FINE AND IMPRISONMENT.

NOTE: TOPOGRAPHIC DATUM IS NAVD 1988. ADD 1.21 FT TO CONVERT TO NGVD 1929 DATUM

THE 2016 STANDARD SPECIFICATION OF NEW JERSEY  
TURNPIKE AUTHORITY, AS AMENDED BY SUPPLEMENTARY  
SPECIFICATIONS, TO GOVERN.

Valerie A Hrabal

Recommended \_\_\_\_\_ *Valerie A Hrabal*

GREENMAN-PEDERSEN, INC.  
NEW JERSEY PROFESSIONAL ENGINEERS  
LICENSE NO: 24602961500  
CERTIFICATE OF AUTHORIZATION NO. 246AR00001

Digitally signed by  
Valerie A Hrabal  
Date: 2023.05.04  
12:20:10 -04'00'

Valerie A  
Hrabal

Digitally signed by  
Valerie A Hrabal  
Date: 2023.05.04  
12:20:10 -04'00'

PLOT BY:  
PLOT DATE:  
CADD FILE:

PLT01.DWG 4/28/2023 12:23:01 PM 1756628 PA\_P-GN\_0001.SHT  
1756628 PA\_P-GN\_0001.SHT - TITLE SHEET AND STANDARD LEGEND LAYOUT FOR 200 PA 2-20 0001.SHT

## LEGEND

(CONCEPTUAL ONLY - NOT TO PLAN SCALE)

### ROADWAY

### ITEM

PROPERTY LINE \_\_\_\_\_  
FENCE \_\_\_\_\_ SEE NOTE 7  
RIGHT OF WAY \_\_\_\_\_  
DENIAL OF ACCESS LINE \_\_\_\_\_  
EASEMENT LINE \_\_\_\_\_  
GUIDE RAIL \_\_\_\_\_  
EDGE OF ROADWAY PAVEMENT \_\_\_\_\_  
EDGE OF SHOULDER PAVEMENT \_\_\_\_\_  
GROUND CONTOUR \_\_\_\_\_  
BORING LOCATION \_\_\_\_\_  
CURB \_\_\_\_\_  
DEPRESSED CURB \_\_\_\_\_  
SIGN \_\_\_\_\_  
CONCRETE MONUMENT \_\_\_\_\_  
IMPACT ATTENUATOR \_\_\_\_\_  
CONCRETE BARRIER \_\_\_\_\_  
DIRECTION OF TRAFFIC \_\_\_\_\_

### BASELINE CURVE DATA REFERENCE

### DRAINAGE

STORM DRAIN \_\_\_\_\_  
SANITARY SEWER \_\_\_\_\_  
UNDERDRAIN \_\_\_\_\_  
HEADWALL \_\_\_\_\_  
DROP INLET OR CATCH BASIN \_\_\_\_\_  
RESET INLET OR CATCH BASIN \_\_\_\_\_  
MANHOLE \_\_\_\_\_  
RESET MANHOLE \_\_\_\_\_  
LIP CURB INLET \_\_\_\_\_  
FLARED END SECTION \_\_\_\_\_  
PAVED DITCH OR CHANNEL \_\_\_\_\_  
UNPAVED DITCH OR CHANNEL \_\_\_\_\_  
STREAM \_\_\_\_\_  
BLEEDER DRAIN \_\_\_\_\_

### UTILITIES

TELEPHONE OR COMMUNICATIONS LINE OVERHEAD \_\_\_\_\_  
TELEPHONE OR COMMUNICATIONS LINE UNDERGROUND \_\_\_\_\_  
POWER LINE OVERHEAD \_\_\_\_\_  
POWER LINE UNDERGROUND \_\_\_\_\_  
WATER MAIN \_\_\_\_\_  
WATER MAIN VALVE \_\_\_\_\_  
WATER HYDRANT \_\_\_\_\_  
MANHOLE \_\_\_\_\_  
GAS PIPELINE \_\_\_\_\_  
PETROLEUM PIPELINE \_\_\_\_\_  
COMMUNICATIONS CABLE UNDERGROUND \_\_\_\_\_  
COMMUNICATIONS CABLE OVERHEAD \_\_\_\_\_  
FIBER OPTIC CABLE OVERHEAD \_\_\_\_\_  
FIBER OPTIC CABLE UNDERGROUND \_\_\_\_\_  
UTILITY POLE \_\_\_\_\_  
RAILROAD COMMUNICATION OR SIGNAL LINE OVERHEAD \_\_\_\_\_  
RAILROAD COMMUNICATION OR SIGNAL LINE UNDERGROUND \_\_\_\_\_  
UTILITY CASING \_\_\_\_\_  
UTILITY CO. MANHOLE, ELECTRIC (TYPE AND SIZE AS NOTED) \_\_\_\_\_  
UTILITY CO. MANHOLE, TELEPHONE (TYPE AND SIZE AS NOTED) \_\_\_\_\_  
UTILITY CO. HANDHOLE, FIBER OPTIC (TYPE AND SIZE AS NOTED) \_\_\_\_\_

### GENERAL

ABANDON \_\_\_\_\_  
REMOVE \_\_\_\_\_  
DEMOLITION \_\_\_\_\_

MADE	BY	DATE
SCS	SCS	03/20/23
TRACED	SCS	03/20/23
CHECKED	BEK	03/20/23
SUPERVISED	V. HRABAL	

NORTH ARROW

### EXISTING

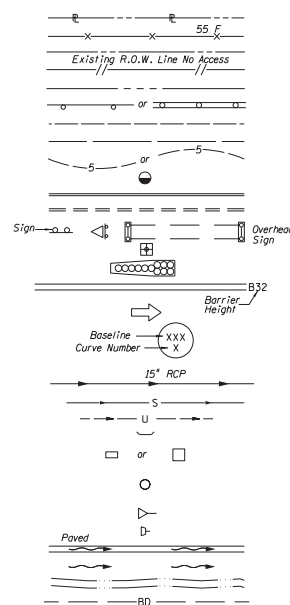

To	To
T	T
Eo	Eo
E	E
8"W	8"W
6"G	6"G
16"P	16"P
CTV	CTV
CTVo	CTVo
Fo	Fo
F/O	F/O
RRo	RRo
RR	RR

E
T
F

ABANDON (TBA)
REMOVE (TBR)

1 Sty Frame (A)
TO BE REMOVED UNDER CLEARING AND GRUBBING

### PROPOSED

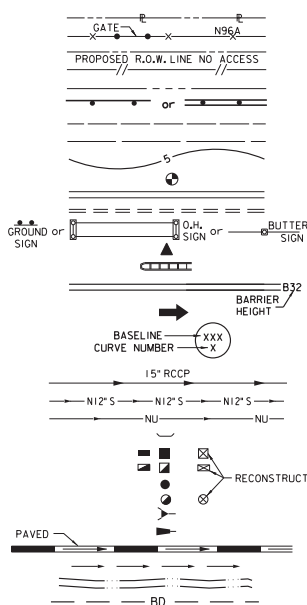

NTo	NTo
NT	NT
NEo	NEo
NE	NE
N8"W	N8"W
N6"G	N6"G
N16"P	N16"P
NCTV	NCTV
NCTVo	NCTVo
NFo	NFo
NF	NF
NRRo	NRRo
NRR	NRR

E
T
F

DEMOLITION OF BUILDING
1 Sty Frame (A)

TO BE REMOVED UNDER CLEARING AND GRUBBING
---

## MISCELLANEOUS ITEMS

### CONCRETE NOSE

### MILLING AND RESURFACING, 2" DEPTH

### COUNTY OR MUNICIPAL LINE

### RAILROAD

### EXISTING MARSH

### EXISTING TREES AND TREE LINE

### EXISTING BUSH AND HEDGE

### SHEETING

### CENTERLINE OR BASELINE

### TOP OF CUT SLOPE

### TOE OF FILL SLOPE

### HEAVY DUTY SILT FENCE, BLACK

### TEMPORARY ORANGE PLASTIC FENCE

### WETLAND DELINEATION

### LIMIT OF CLEARING AND GRUBBING

### TEMPORARY SNAKE FENCE

### TEMPORARY INLET PROTECTION

### TEST PIT

### PAVEMENT CORE

### WETLAND

### RIPRAP

### MILLING, LEVELING & RESURFACING

### HIGH POINT

### LOW POINT

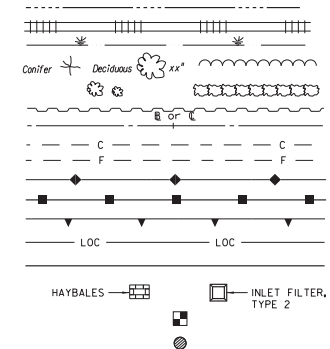

## GENERAL NOTES

- ALL SUPPLEMENTAL HORIZONTAL AND VERTICAL CONTROL POINTS ARE DERIVED FROM PRIMARY CONTROL POINTS SURVEYED BY KMA CONSULTING ENGINEERS DETAILED IN A SURVEY CONTROL REPORT DATED APRIL 18, 2022.
- THE HORIZONTAL CONTROL COORDINATE VALUES ARE IN THE NEW JERSEY STATE PLANE COORDINATE SYSTEM (NAD83 (2011)). A COMBINED SCALE FACTOR OF 1.000088889 SHOULD BE APPLIED TO CONVERT FROM NAD83 (GRID) TO GROUND COORDINATE VALUES.
- THE VERTICAL DATUM IS IN THE NORTH AMERICAN VERTICAL DATUM 1998 (NAVD88).
- SUBSURFACE INFORMATION SHOWN ON THESE PLANS WAS OBTAINED SOLELY FOR USE IN ESTABLISHING DESIGN CONTROLS FOR THE PROJECT. THE ACCURACY OF THIS INFORMATION IS NOT GUARANTEED.
- THE INFORMATION SHOWN ON THESE PLANS CONCERNING TYPE AND LOCATION OF UNDERGROUND UTILITIES IS NOT GUARANTEED TO BE ACCURATE OR ALL INCLUSIVE. THE CONTRACTOR IS RESPONSIBLE FOR MAKING HIS OWN DETERMINATIONS AS TO THE TYPE AND LOCATION OF UNDERGROUND UTILITIES AS MAY BE NECESSARY TO AVOID DAMAGE THERETO.
- IN ORDER TO PROVIDE A SUFFICIENT LEVEL OF LEGIBILITY ON THE PLAN SHEETS, NOT ALL SUBSURFACE FEATURES (EXISTING AND / OR PROPOSED) ARE SHOWN ON EVERY PLAN SHEET. THE CONTRACTOR IS DIRECTED TO REVIEW EACH SECTION OF THE PLAN SHEETS (HIGHWAY, DRAINAGE, UTILITY, HIGHWAY LIGHTING, ETC.) IN ORDER TO ACCOUNT FOR ALL SUBSURFACE FEATURES AND TO ENSURE PROPER COORDINATION OF THE WORK ITEMS OF THIS CONTRACT.
- THE SUFFIX LETTER DESIGNATIONS USED IN THE SYMBOL ARE AS FOLLOWS: F-FARM FENCE, A-ALUMINUM COATED CHAIN LINK, B-BARBED WIRE, P-PVC COATED CHAIN LINK, AND T-TEMPORARY. THE NUMERICAL VALUE USED INDICATES HEIGHT OF FABRIC IN INCHES.
- CONTRACTOR SHALL OBTAIN ONE-CALL UTILITY MARKOUT AND PERFORM TEST PITS TO VERIFY LOCATION OF PENTA FACILITIES, AND SHALL BE RESPONSIBLE TO PROVIDE AND COORDINATE PROTECTION FOR THESE FACILITIES DURING CONSTRUCTION. A PENTA INSPECTOR MUST BE ONSITE DURING ALL EXCAVATION WITHIN 5 FEET OF PENTA FACILITIES.

Digitally signed  
by Valerie A  
Hrabal  
Date: 2023.05.04  
12:23:01 -04'00'

0 1/2 2 3 4  
ORIGINAL SIZE IN INCHES

REV.	DESCRIPTION	DATE	BY	CHK.

NEW JERSEY TURNPIKE AUTHORITY  
**GARDEN STATE PARKWAY**  
PRELIMINARY ENGINEERING AND ENVIRONMENTAL PERMITTING  
FOR OPERATIONAL IMPROVEMENTS, MILEPOST 80 TO 83  
  
GENERAL LEGEND -1-  
  
GREENMAN-PEDERSEN, INC.  
100 CORPORATE DRIVE, SUITE 301, LEBANON, NJ 08833  
CERTIFICATE OF AUTHORIZATION NO. 240A27959500  
  
Valerie A. Hrabal  
NEW JERSEY PROFESSIONAL ENGINEER NO. 460505081000  
  
SCALE: NONE  
DATE: MAY 2023

2  
16

FILENAME: 1756628 PA\_P-GN\_0001.SHT

BOROUGH OF SOUTH TOMS RIVER  
BOROUGH OF BEACHWOOD  
BERKELEY TOWNSHIP

COUNTY OF OCEAN

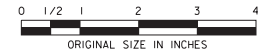
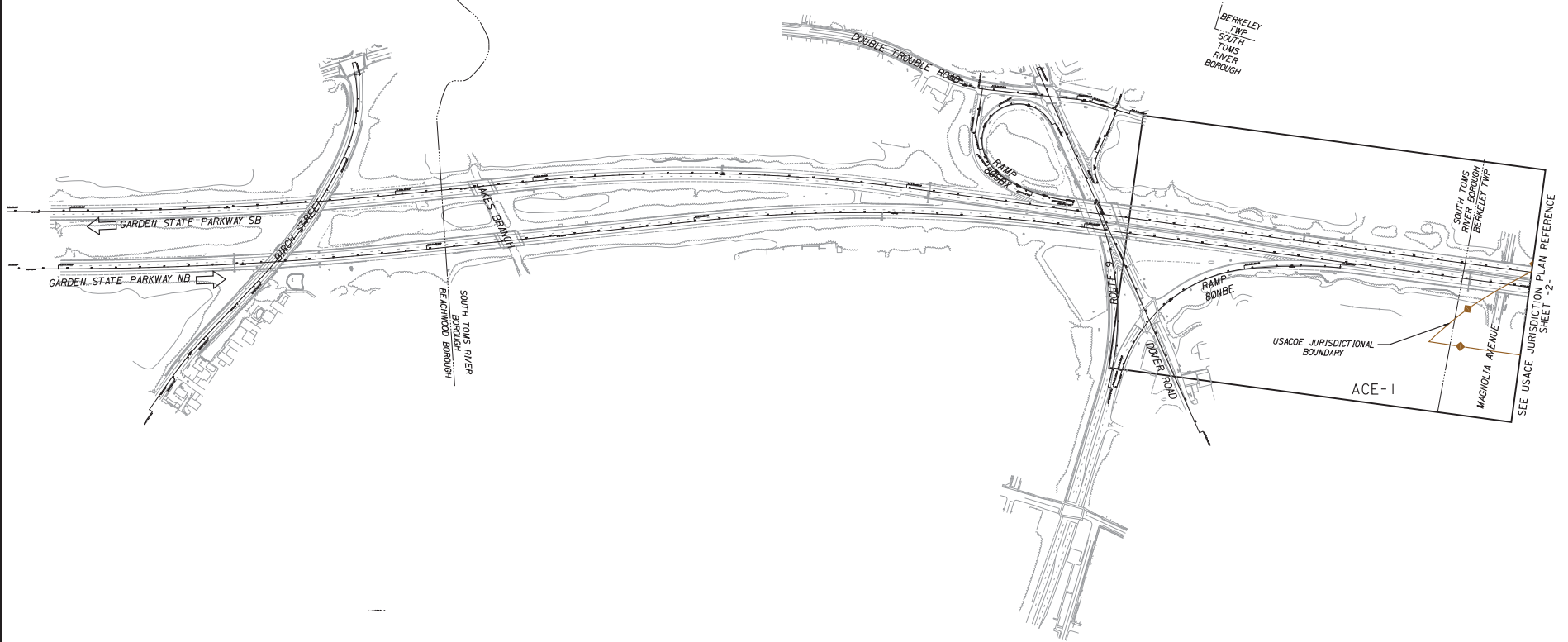
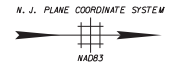

PR-1  
PR-3

NEW JERSEY TURNPIKE AUTHORITY	
<b>GARDEN STATE PARKWAY</b>	
PRELIMINARY ENGINEERING AND ENVIRONMENTAL PERMITTING FOR OPERATIONAL IMPROVEMENTS, MILEPOST 80 TO 83	
USACE JURISDICTION PLAN REFERENCE SHEET -1-	
Digitally signed by Valerie A Hrabal Date: 2023.05. 12:25:21 -0400	GREENMAN PEDERSEN, INC. 100 CORPORATE DRIVE, SUITE 301, LEBANON, NJ 08833 CERTIFICATE OF AUTHORIZATION NO. 24GA27959500 <i>Valerie A. Hrabal</i> VALERIE A. HRABAL NEW JERSEY PROFESSIONAL ENGINEER NO. 440620861000
SCALE: 1"=200'	DATE: MAY 2023

Valerie  
A Hrabal

LEGEND  
ACE = USACE JURISDICTION PLANS

	BY	DATE
MADE	SCS	03/2023
TRACED	SCS	03/2023
CHECKED	BEK	03/2023
SUPERVISED	V. HRABAL	

FILENAME: R0225200\_USACE-P\_PSI\_0001.SHT

TOWNSHIP OF TOMS RIVER  
BERKELEY TOWNSHIP  
SOUTH TOMS RIVER BOROUGH

COUNTY OF OCEAN

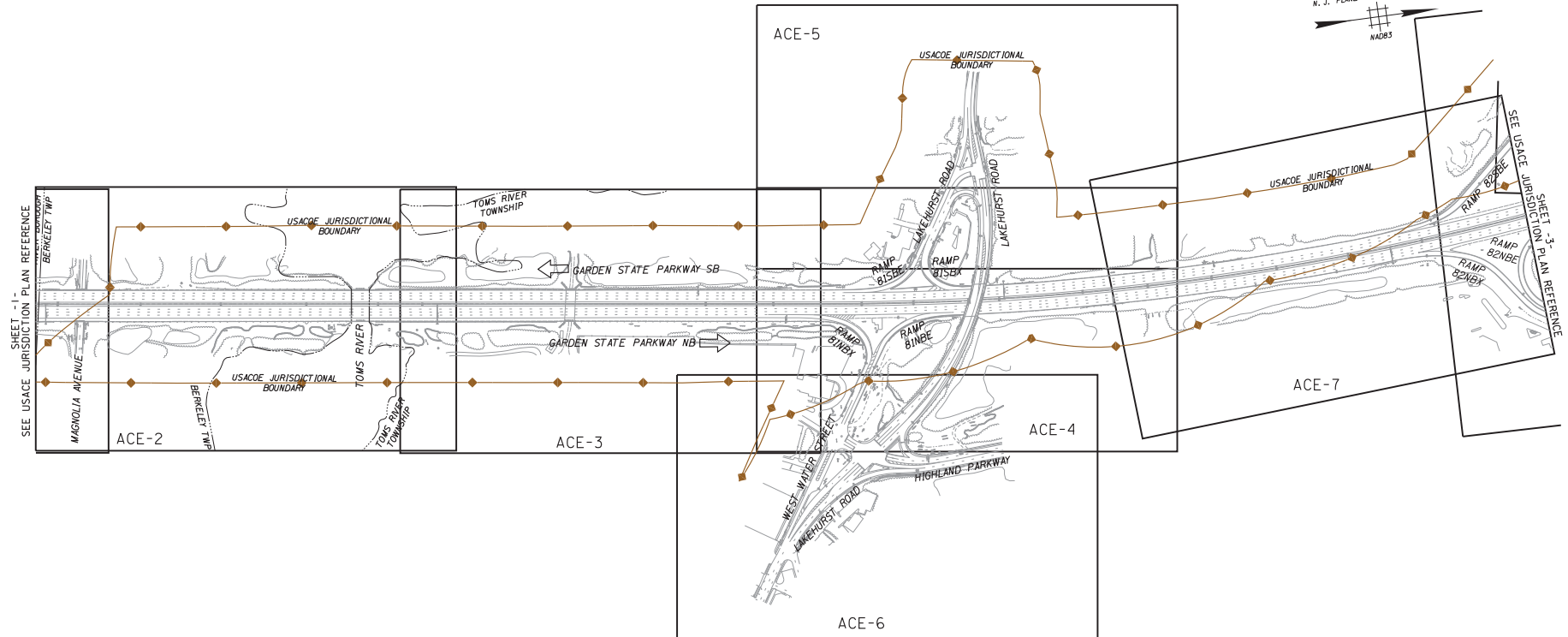
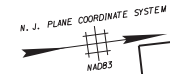

SHEET -1-1  
SEE USACE JURISDICTION PLAN REFERENCE

SHEET -3-3  
SEE USACE JURISDICTION PLAN REFERENCE

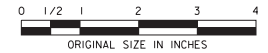

PR-2  
PR-3

NEW JERSEY TURNPIKE AUTHORITY  
**GARDEN STATE PARKWAY**

PRELIMINARY ENGINEERING AND ENVIRONMENTAL PERMITTING  
FOR OPERATIONAL IMPROVEMENTS, MILEPOST 80 TO 83

USACE JURISDICTION PLAN REFERENCE  
SHEET -2-

GREENMAN-PEDERSEN, INC.  
100 CORPORATE DRIVE, SUITE 301, LEBANON, NJ 08833  
CERTIFICATE OF AUTHORIZATION NO. 24GAZ7959500

*Valerie A. Hrabal*  
VALERIE A. HRABAL  
NEW JERSEY PROFESSIONAL ENGINEER NO. 44063286100

SCALE: 1"=200'  
DATE: MAY 2023

4  
16

Digitally signed by  
Valerie A  
Hrabal  
Date:  
2023.05.04  
12:27:36  
-04'00'

FILENAME: R0425200\_USACE-P\_PSI\_0002.SHT

PRINT NO: 60074030  
DATE: 4/28/2023 12:56:28 PM  
PROJECT: 2023-05-04 USACE-P\_PSI\_0002.SHT  
DRAWING: 2023-05-04 USACE-P\_PSI\_0002.SHT  
SHEET: 2023-05-04 USACE-P\_PSI\_0002.SHT

	BY	DATE
MADE	SCS	03/2023
TRACED	SCS	03/2023
CHECKED	BEK	03/2023
SUPERVISED	V. HRABAL	

LEGEND  
ACE = USACE JURISDICTION PLANS

TOWNSHIP OF TOMS RIVER

COUNTY OF OCEAN

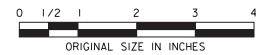
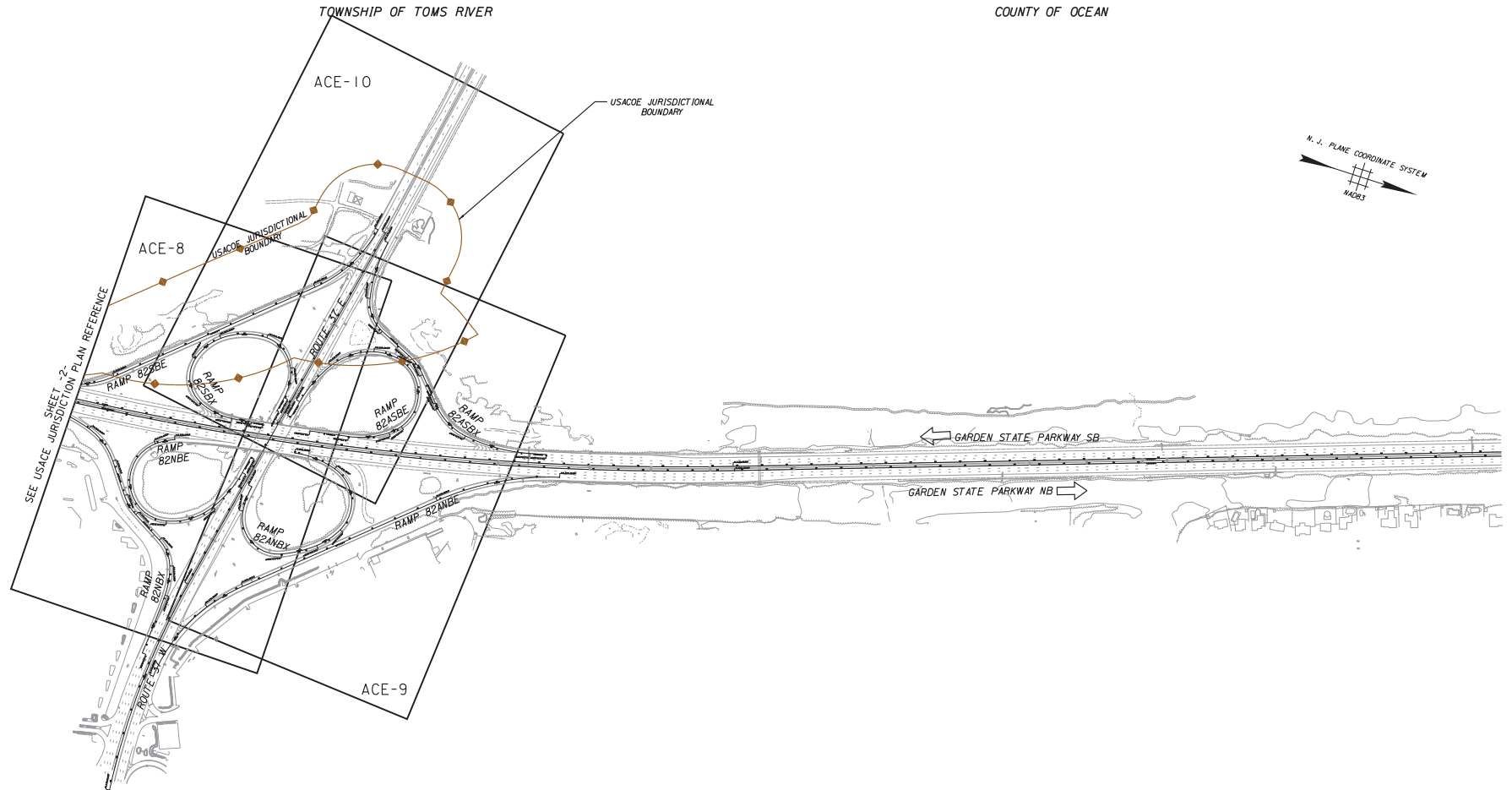

PR-3  
PR-3

NEW JERSEY TURNPIKE AUTHORITY  
**GARDEN STATE PARKWAY**  
PRELIMINARY ENGINEERING AND ENVIRONMENTAL PERMITTING  
FOR OPERATIONAL IMPROVEMENTS, MILEPOST 80 TO 83

USACE JURISDICTION PLAN REFERENCE  
SHEET -3-

GREENMAN-PEDERSEN, INC.  
100 CORPORATE DRIVE, SUITE 301, LEBANON, NJ 08833  
CERTIFICATE OF AUTHORIZATION NO. 24GAZ7959500  
Date: 2023.05.04  
12:29:46 -0400  
Valerie A. Hrabal  
NEW JERSEY TURNPIKE AUTHORITY  
CERTIFICATE NO. 24G020281000

SCALE: 1"=200'  
DATE: MAY 2023

5  
16

FILENAME: R0225200\_USACE-P\_PSI\_0003.SHT

Valerie A. Hrabal  
Digitally signed by Valerie A. Hrabal  
Date: 2023.05.04  
12:29:46 -0400

LEGEND  
ACE = USACE JURISDICTION PLANS

BY	DATE
MADE	SCS 03/2023
TRACED	SCS 03/2023
CHECKED	BEK 03/2023
SUPERVISED	V. HRABAL

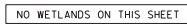

Digitally signed by Valerie A Hrabal  
Date: 2023.05.04 12:31:57

GREENMAN-PEDERSEN, INC.  
100 CORPORATE DRIVE, SUITE 301, LEBANON, NJ 08833  
CERTIFICATE OF AUTHORIZATION NO. 24GA27959500

ACE-1  
ACE-10

REV.	DESCRIPTION	DATE	BY	CHK

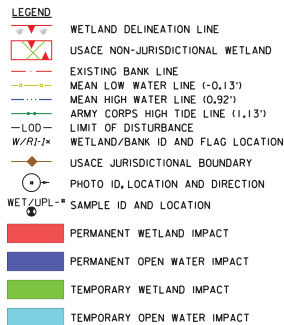



WETLAND/STATE OPEN WATER ID	ACREAGE
WETLAND 46	0.165
WETLAND 47	0.785
WETLAND 56	0.077
WETLAND 57	0.225
STATE OPEN WATER 15 (TOMS RIVER)	5.927

	A Hrabal	Date:	2023.05.04	
		Time:	12:47:59 -'04'00'	
REV.	DESCRIPTION	DATE	R/Y	C/H

GREENMAN-PEDERSEN, INC.  
100 CORPORATE DRIVE, SUITE 301, LEBANON, NJ 08833  
CERTIFICATE OF AUTHORIZATION NO. 24GA27959500  
*Valerie A. Hrabal*  
VALERIE A. HRABAL  
NEW JERSEY PROFESSIONAL ENGINEER NO. 24GE02961500  
FILENAME: \R3828-200\_USACE-P\_0002.SHT

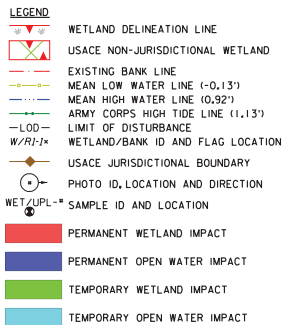
SCALE: 1"=50'  
DATE: MAY 2023



<p>NEW JERSEY TURNPIKE AUTHORITY</p> <h1 style="margin: 0;">GARDEN STATE PARKWAY</h1>	
<p>PRELIMINARY ENGINEERING AND ENVIRONMENTAL PERMITTING FOR OPERATIONAL IMPROVEMENTS, MILEPOST 80 TO 83</p>	
<p>USACE JURISDICTION PLAN -3-</p>	
<p>GREENBERG FARDEN, INC. 100 CORTLANDT AVE., SUITE 800, LEBANON, NJ 08833 CERTIFICATE OF AUTHORIZATION NO. 246247955900 <i>Robert A. HARRAS</i> VIA BRIAN A. HARRAS NEW JERSEY TURNPIKE AUTHORITY 100 CORTLANDT AVE., SUITE 800, LEBANON, NJ 08833</p>	<p>SCALE: 1"=50' DATE: MAY 2023</p> <div style="text-align: center;">  </div>

Digitally signed by Valerie A Hrabal  
Date: 2023.05.04 12:51:48 -04'00'

REV.	DESCRIPTION	DATE	RY	CHK
------	-------------	------	----	-----

TOWNSHIP OF TOMS RIVER

COUNTY OF OCEAN

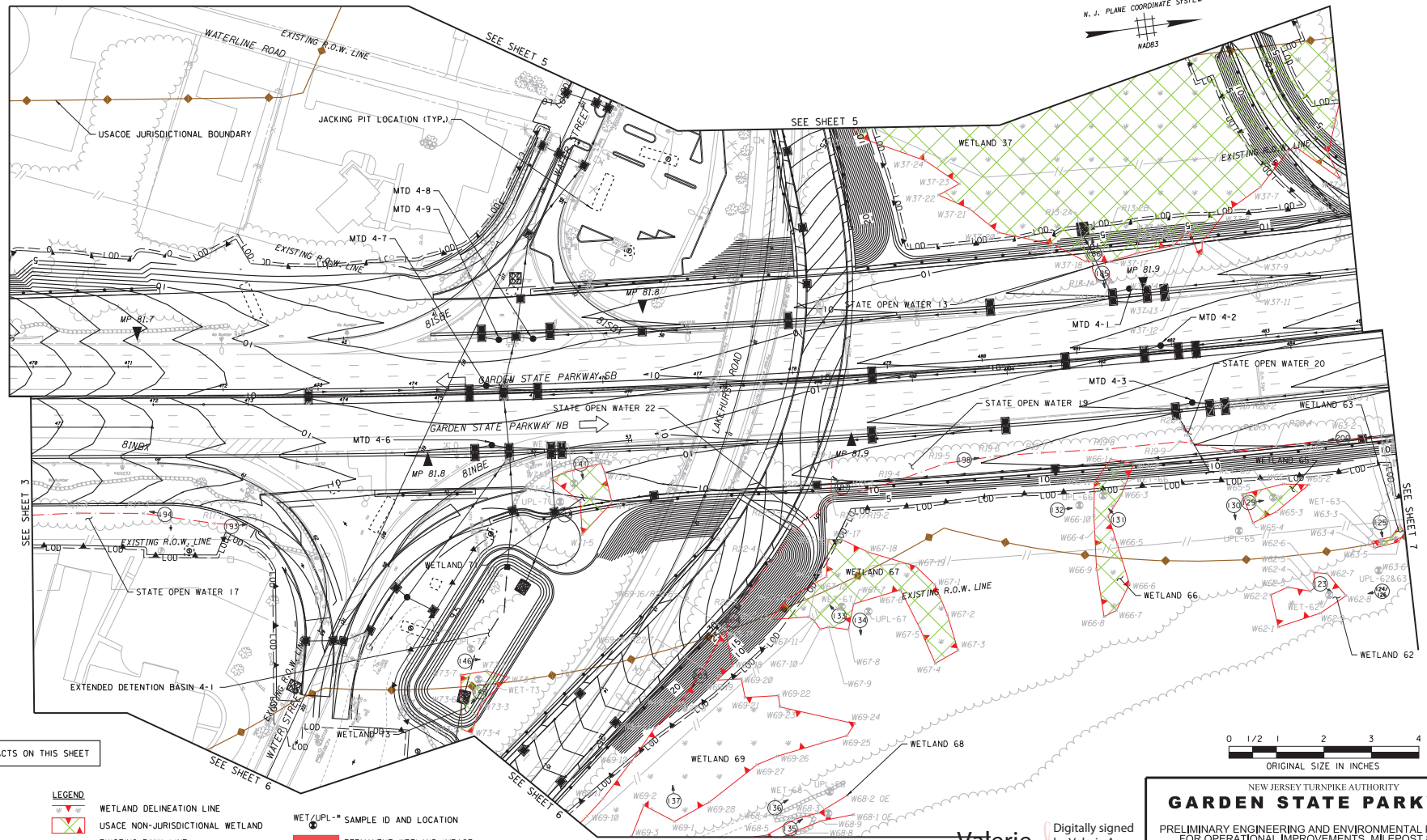

NO IMPACTS ON THIS SHEET

## LEGEND

- WETLAND DELINEATION LINE
- USACE NON-JURISDICTIONAL WETLAND
- EXISTING BANK LINE
- MEAN LOW WATER LINE (-0.13')
- MEAN HIGH WATER LINE (0.92')
- ARMY CORPS HIGH TIDE LINE (1.13')
- LIMIT OF DISTURBANCE
- WETLAND/BANK ID AND FLAG LOCATION
- USACE JURISDICTIONAL BOUNDARY
- PHOTO ID, LOCATION AND DIRECTION

WET/UPL-# SAMPLE ID AND LOCATION

- PERMANENT WETLAND IMPACT
- PERMANENT OPEN WATER IMPACT
- TEMPORARY WETLAND IMPACT
- TEMPORARY OPEN WATER IMPACT

WETLAND/STATE OPEN WATER ID	ACREAGE
WETLAND 37	1.476
WETLAND 63	0.004
WETLAND 65	0.033
WETLAND 66	0.057
WETLAND 67	0.056

Valerie A Hrabal  
Digitally signed by Valerie A Hrabal  
Date: 2023.05.04 12:54:07 -04'00'

0 1/2 1 2 3 4  
ORIGINAL SIZE IN INCHES

NEW JERSEY TURNPIKE AUTHORITY  
**GARDEN STATE PARKWAY**  
PRELIMINARY ENGINEERING AND ENVIRONMENTAL PERMITTING  
FOR OPERATIONAL IMPROVEMENTS, MILEPOST 80 TO 83

USACE JURISDICTION PLAN -4-

GREENMAN-PEDERSEN, INC.  
100 CORPORATE DRIVE, SUITE 301, LEBANON, NJ 08833  
CERTIFICATE OF AUTHORIZATION NO. 240A27959000

Valerie A Hrabal  
NEW JERSEY TURNPIKE AUTHORITY  
CERTIFICATE OF AUTHORIZATION NO. 240A27959000

SCALE: 1"=50'  
DATE: MAY 2023

9  
16

FILENAME: R002200\_USACE-P\_0004.SHT

PLANT NO: 6004-0004  
DATE: 4/28/2023  
TIME: 12:54:07 PM  
PROJECT: GARDEN STATE PARKWAY OPERATIONAL IMPROVEMENTS, MILEPOST 80 TO 83  
SHEET: 4 OF 16  
DRAWN BY: V. HRABAL  
CHECKED BY: BEK  
SUPERVISED BY: V. HRABAL

BY	DATE
MADE	SCS 03/2023
TRACED	SCS 03/2023
CHECKED	BEK 03/2023
SUPERVISED	V. HRABAL

TOWNSHIP OF TOMS RIVER

COUNTY OF OCEAN

## LEGEND

- WETLAND DELINEATION LINE  
USACE NON-JURISDICTIONAL WETLAND  
EXISTING BANK LINE  
MEAN LOW WATER LINE (-0.13')  
MEAN HIGH WATER LINE (0.92')  
ARMY CORPS HIGH TIDE LINE (1.13')  
LIMIT OF DISTURBANCE  
WETLAND/BANK ID AND FLAG LOCATION  
USACE JURISDICTIONAL BOUNDARY  
PHOTO ID, LOCATION AND DIRECTION  
WET/UPL-SAMPLE ID AND LOCATION  
PERMANENT WETLAND IMPACT  
PERMANENT OPEN WATER IMPACT  
TEMPORARY WETLAND IMPACT  
TEMPORARY OPEN WATER IMPACT

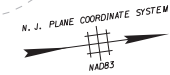

WETLAND/STATE OPEN WATER ID	ACREAGE
WETLAND 37	1.623
WETLAND 38	0.718
WETLAND 39	0.579
WETLAND 40	0.966
WETLAND 41	0.122
WETLAND 42	0.624
STATE OPEN WATER 12 (TOMS RIVER)	0.869

SUMMARY OF USACE WETLAND IMPACTS				
PERM. WETLAND IMPACT	TEMP. WETLAND IMPACT	PERM. OPEN WATER IMPACT	TEMP. OPEN WATER IMPACT	TOTAL IMPACT
10,607 SF (0.243 AC)	0 SF (0 AC)	0 SF (0 AC)	0 SF (0 AC)	10,607 SF (0.243 AC)

BY	DATE
MADE	SCS 03/2023
TRACED	SCS 03/2023
CHECKED	BEK 03/2023
SUPERVISED	V. HRABAL

Valerie A Hrabal  
Digitally signed by Valerie A Hrabal  
Date: 2023.05.04 12:56:49 -04'00'

NEW JERSEY TURNPIKE AUTHORITY	
<b>GARDEN STATE PARKWAY</b>	
PRELIMINARY ENGINEERING AND ENVIRONMENTAL PERMITTING FOR OPERATIONAL IMPROVEMENTS, MILEPOST 80 TO 83	
USACE JURISDICTION PLAN -5-	
GREENMAN-PEDERSEN, INC. 100 CORPORATE DRIVE, SUITE 301, LEBANON, NJ 08833 CERTIFICATE OF AUTHORIZATION NO. 240A2795900 Valerie A Hrabal NEW JERSEY TURNPIKE AUTHORITY ENGINEER NO. 24050200100	SCALE: 1"=50' DATE: MAY 2023

FILENAME: R0825200\_USACE-P\_0005.SHT

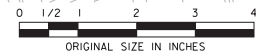
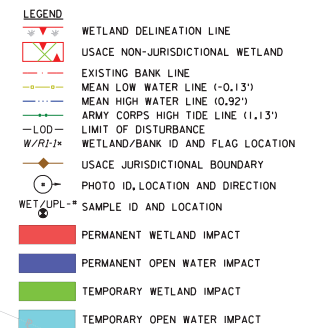
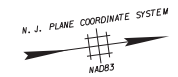

NEW JERSEY TURNPIKE AUTHORITY  
**GARDEN STATE PARKWAY**  
PRELIMINARY ENGINEERING AND ENVIRONMENTAL PERMITTING  
FOR OPERATIONAL IMPROVEMENTS, MILEPOST 80 TO 83

USACE JURISDICTION PLAN -6-

Valerie  
A Hrabal

GREENMAN PEDERSEN, INC.  
100 CORPORATE DRIVE, SUITE 301, LEBANON, NJ 08833  
CERTIFICATE OF AUTHORIZATION NO. 24GA27959500

SCALE: 1"=50'  
DATE: MAY 2023

VALERIA A. HRABALA  
NEW YORK STATE PROFESSIONAL ENGINEER NO. 24GE02961500  
FILE NAME: NEW-238228-100, USACE P. 0006 SW

FILENAME: R3828-200\_USACE-P\_0006.SHT

	BY	DATE
MADE	SCS	03/2023
TRACED	SCS	03/2023
CHECKED	BEK	03/2023
SUPERVISED	V. HRBAL	

NO IMPACTS ON THIS SHEET

REV.	DESCRIPTION	DATE	BY	CHK

REV.	DESCRIPTION	DATE	BY	CHK
------	-------------	------	----	-----

TOWNSHIP OF TOMS RIVER

COUNTY OF OCEAN

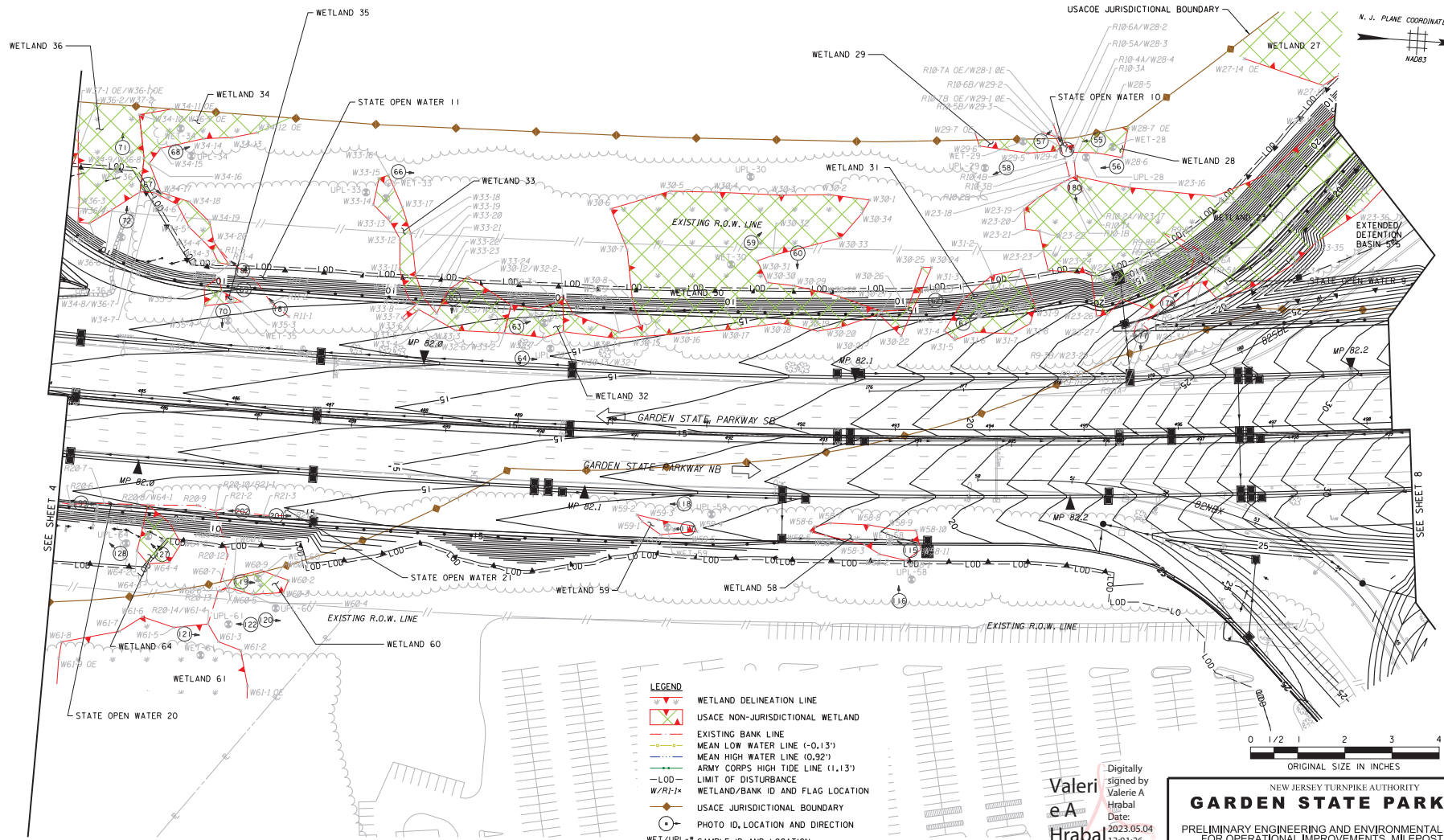
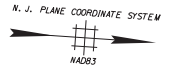

- LEGEND**
- WETLAND DELINEATION LINE
  - USACE NON-JURISDICTIONAL WETLAND
  - EXISTING BANK LINE
  - MEAN LOW WATER LINE (-0.13')
  - MEAN HIGH WATER LINE (0.32')
  - ARMY CORPS HIGH TIDE LINE (1.13')
  - LIMIT OF DISTURBANCE
  - WETLAND/BANK ID AND FLAG LOCATION
  - USACE JURISDICTIONAL BOUNDARY
  - PHOTO ID, LOCATION AND DIRECTION
  - WET/UPL - SAMPLE ID AND LOCATION
  - PERMANENT WETLAND IMPACT
  - PERMANENT OPEN WATER IMPACT
  - TEMPORARY WETLAND IMPACT
  - TEMPORARY OPEN WATER IMPACT

NO IMPACTS ON THIS SHEET

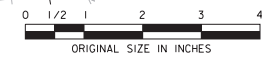

WETLAND/STATE OPEN WATER ID	ACREAGE
WETLAND 23	0.878
WETLAND 27	0.145
WETLAND 28	0.031
WETLAND 29	0.024
WETLAND 30	0.744
WETLAND 31	0.102
WETLAND 32	0.043

WETLAND/STATE OPEN WATER ID	ACREAGE
WETLAND 33	0.134
WETLAND 34	0.129
WETLAND 35	0.013
WETLAND 36	0.176
WETLAND 60	0.002
WETLAND 64	0.042

Digitally  
signed by  
Valerie A  
Hrabal  
Date:  
2023.05.04  
13:01:26  
+04'00'

NEW JERSEY TURNPIKE AUTHORITY

**GARDEN STATE PARKWAY**

PRELIMINARY ENGINEERING AND ENVIRONMENTAL PERMITTING  
FOR OPERATIONAL IMPROVEMENTS, MILEPOST 80 TO 83

USACE JURISDICTION PLAN -7-

GREENMAN-PEDERSEN, INC.  
100 CORPORATE DRIVE, SUITE 301, LEBANON, NJ 08833  
CERTIFICATE OF AUTHORIZATION NO. 24GAZ7959500

Valerie A. Hrabal  
NEW JERSEY TURNPIKE AUTHORITY  
DESIGNER NO. 24050000000

SCALE: 1"=50'  
DATE: MAY 2023

FILE NAME: R022000\_USACE-P\_0007.SHT

PLANT NO: 6007-0000  
TOWNSHIP OF TOMS RIVER, NEW JERSEY  
COUNTY OF OCEAN, NEW JERSEY  
PROJECT NO: 24GAZ7959500 - GARDEN STATE PARKWAY IMPROVEMENTS, MILEPOST 80 TO 83  
SHEET NO: 7 OF 10

DATE	BY	DESCRIPTION
03/20/23	SCS	MADE
03/20/23	SCS	TRACED
03/20/23	BEK	CHECKED
03/20/23	V. HRABAL	SUPERVISED

ACE-7  
ACE-10

12  
16

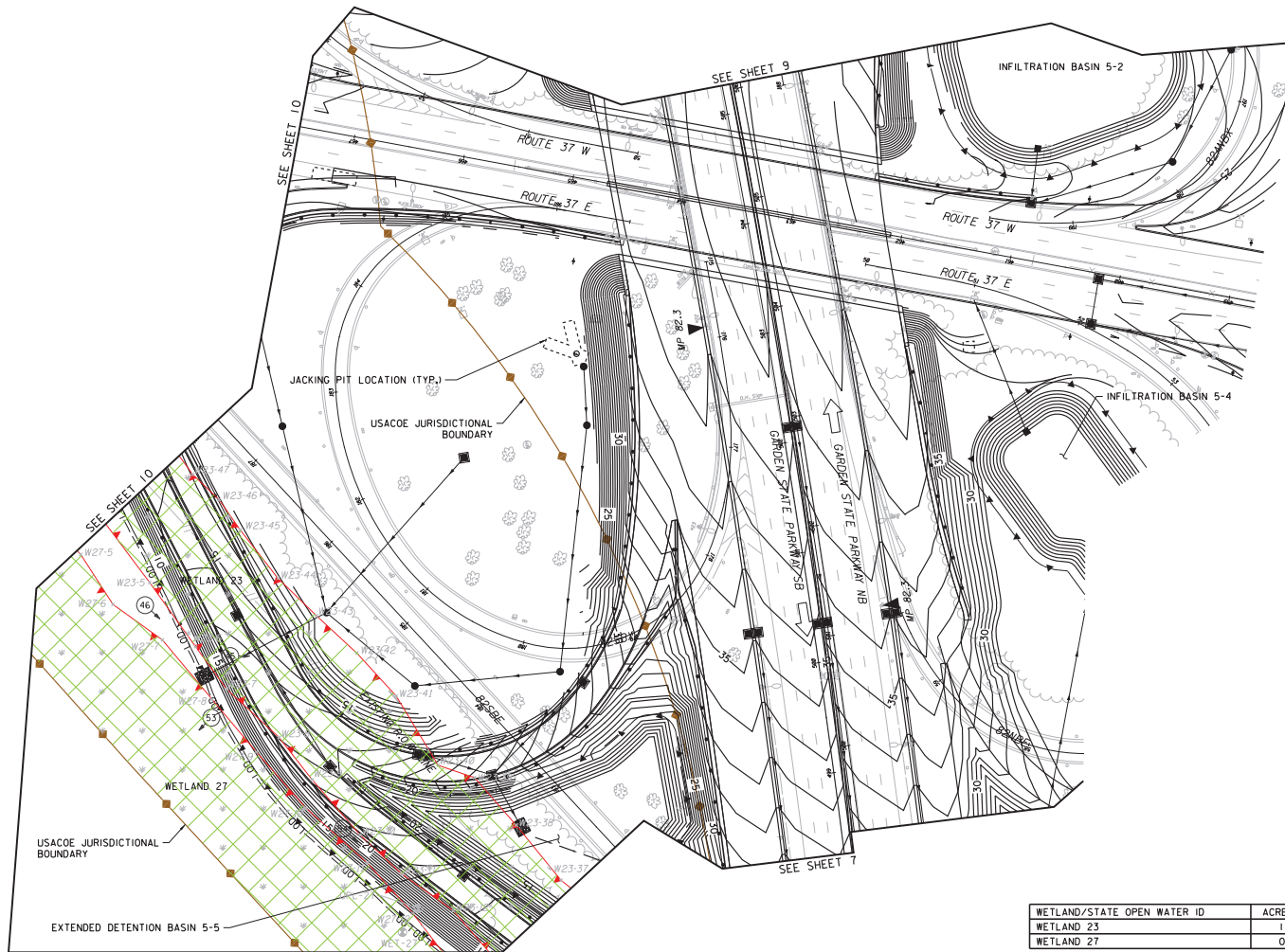

- | LEGEND |                                   |
|--------|-----------------------------------|
|        | WETLAND DELINEATION LINE          |
|        | USACE NON-JURISDICTIONAL WETLAND  |
|        | EXISTING BANK LINE                |
|        | MEAN LOW WATER LINE (-0.13')      |
|        | MEAN HIGH WATER LINE (0.92')      |
|        | ARMY CORPS HIGH TIDE LINE (1.13') |
|        | LIMIT OF DISTURBANCE              |
|        | WETLAND/BANK ID AND FLAG LOCATION |
|        | USACE JURISDICTIONAL BOUNDARY     |
|        | PHOTO ID, LOCATION AND DIRECTION  |
|        | WET/UPSL - SAMPLE ID AND LOCATION |
|        | PERMANENT WETLAND IMPACT          |
|        | PERMANENT OPEN WATER IMPACT       |
|        | TEMPORARY WETLAND IMPACT          |
|        | TEMPORARY OPEN WATER IMPACT       |

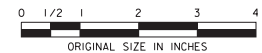

NEW JERSEY TURNPIKE AUTHORITY  
**GARDEN STATE PARKWAY**  
PRELIMINARY ENGINEERING AND ENVIRONMENTAL PERMITTING  
FOR OPERATIONAL IMPROVEMENTS, MILEPOST 80 TO 83

USACE JURISDICTION PLAN -8-

GREENMAN PEDERSEN, INC.  
100 CORPORATE DRIVE, SUITE 301, LEBANON, NJ 08833  
CERTIFICATE OF AUTHORIZATION NO. 24GA27959500

SCALE: 1"=50'  
DATE: MAY 2023

VALERIE A. HRABAL  
NEW YORK STATE PROFESSIONAL ENGINEER NO. 24GE02961500  
FILENAME: R3828-200 USACE-P\_0008.SHT

FILENAME: R3828-200\_USACE-P\_0008.SHT

WETLAND/STATE OPEN WATER ID	ACREAGE
WETLAND 23	1.188
WETLAND 27	0.927

Valerie A Hrabal

				13:04:02 - 04/0
REV.	DESCRIPTION	DATE	BY	CH

	BY	DATE
MADE	SCS	03/2023
TRACED	SCS	03/2023
CHECKED	BEK	03/2023
SUPERVISED	V. HRABAL	

NO IMPACTS ON THIS SHEET

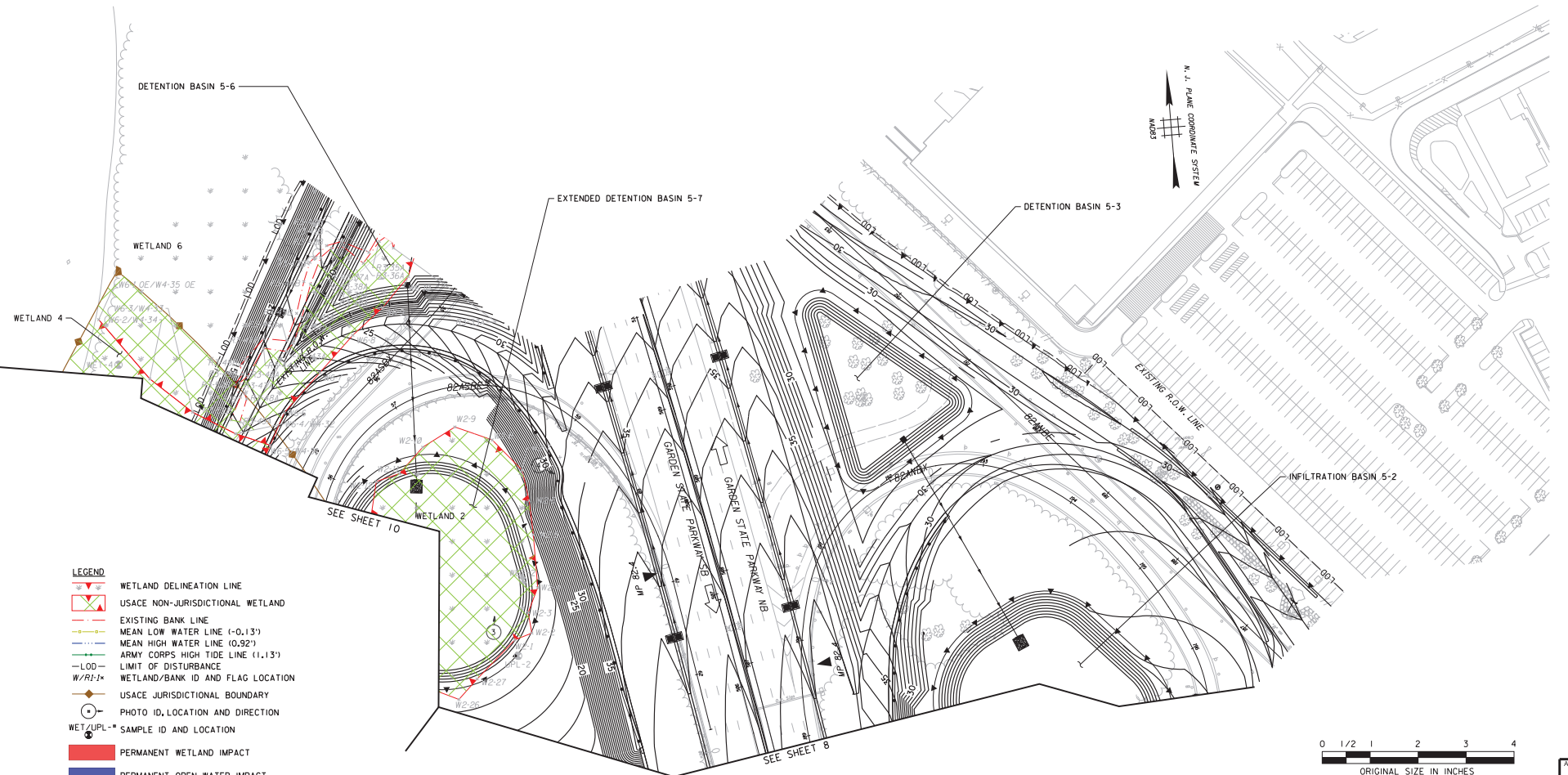

- LEGEND**
- WETLAND DELINEATION LINE
  - USACE NON-JURISDICTIONAL WETLAND
  - EXISTING BANK LINE
  - MEAN LOW WATER LINE (-0.13')
  - MEAN HIGH WATER LINE (0.92')
  - ARMY CORPS HIGH TIDE LINE (1.13')
  - LOD - LIMIT OF DISTURBANCE
  - W/R/I-1 - WETLAND/BANK ID AND FLAG LOCATION
  - USACE JURISDICTIONAL BOUNDARY
  - PHOTO ID, LOCATION AND DIRECTION
  - WET/UPL - SAMPLE ID AND LOCATION
  - PERMANENT WETLAND IMPACT
  - PERMANENT OPEN WATER IMPACT
  - TEMPORARY WETLAND IMPACT
  - TEMPORARY OPEN WATER IMPACT

WETLAND/STATE OPEN WATER ID	ACREAGE
WETLAND 4	0.105
WETLAND 6	0.263

Valerie A Hrabal  
Digitally signed by Valerie A Hrabal  
Date: 2023.05.04 13:06:53 -0400

REV.	DESCRIPTION	DATE	BY	CHK.

0 1/2 1 2 3 4  
ORIGINAL SIZE IN INCHES

ACE-9  
ACE-10

NEW JERSEY TURNPIKE AUTHORITY	
<b>GARDEN STATE PARKWAY</b>	
PRELIMINARY ENGINEERING AND ENVIRONMENTAL PERMITTING FOR OPERATIONAL IMPROVEMENTS, MILEPOST 80 TO 83	
USACE JURISDICTION PLAN -9-	
GREENMAN-PEDERSEN, INC. 100 CORPORATE DRIVE, SUITE 301, LEBANON, NJ 08833 CERTIFICATE OF AUTHORIZATION NO. 24GAZ7959800	
SCALE: 1"=50'	DATE: MAY 2023
VALERIE A. HRABAL NEW JERSEY PROFESSIONAL ENGINEER NO. 44050286100	
FILENAME: R042200_USACE-P_0009.SHT	

NO IMPACTS ON THIS SHEET

BY	DATE
MADE	SCS 03/2023
TRACED	SCS 03/2023
CHECKED	BEK 03/2023
SUPERVISED	V. HRABAL

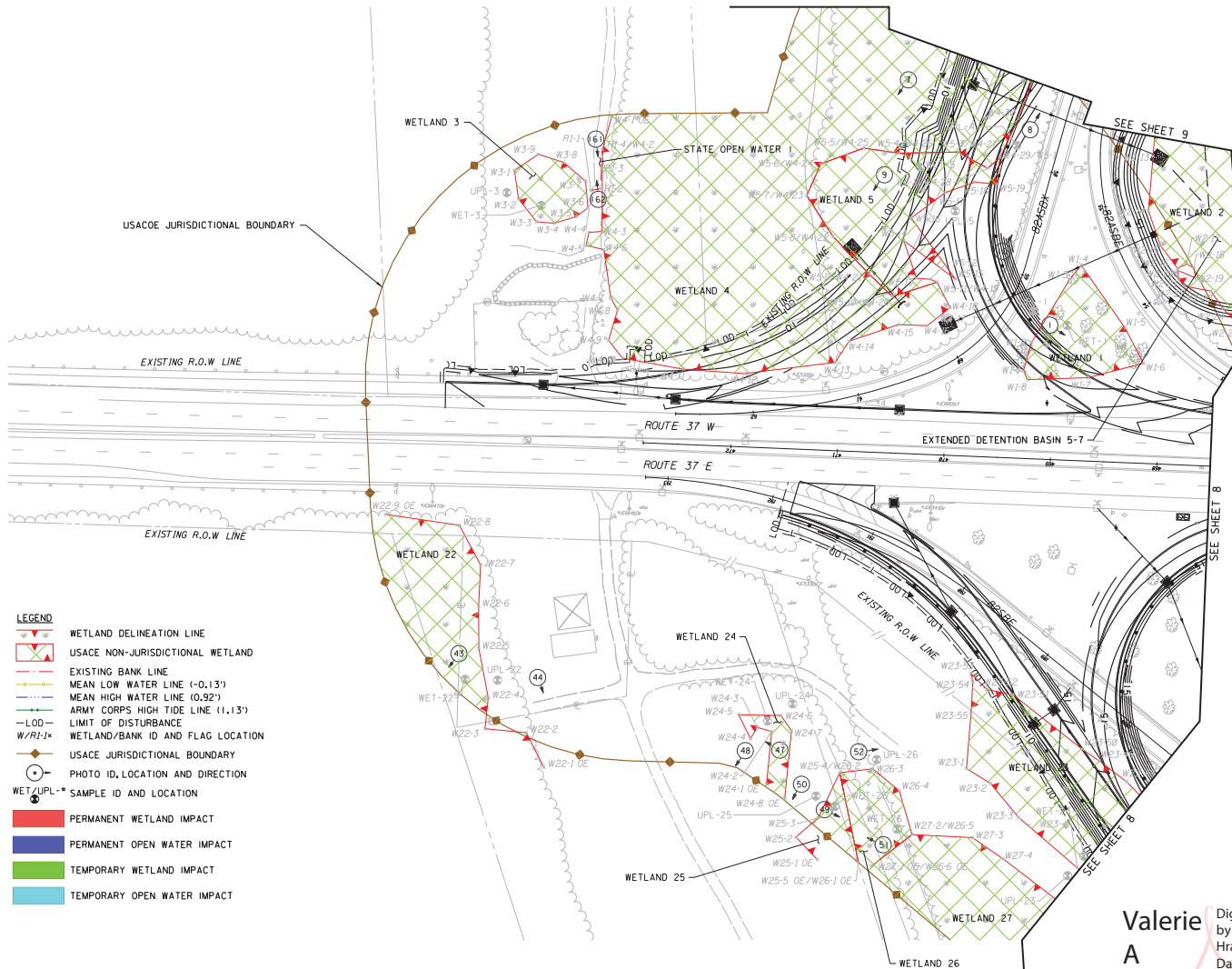

WETLAND/STATE OPEN WATER ID	ACREAGE
WETLAND 1	0.156
WETLAND 2	0.026
WETLAND 3	0.075
WETLAND 4	1.806
WETLAND 5	0.296
WETLAND 22	0.299
WETLAND 23	0.325
WETLAND 24	0.039
WETLAND 25	0.033
WETLAND 26	0.093
WETLAND 27	0.350

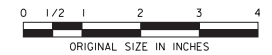

Valerie A Hrabal  
Digitally signed  
by Valerie A Hrabal  
Date: 2023.05.04 13:11:07 -0400

NEW JERSEY TURNPIKE AUTHORITY  
**GARDEN STATE PARKWAY**  
PRELIMINARY ENGINEERING AND ENVIRONMENTAL PERMITTING  
FOR OPERATIONAL IMPROVEMENTS, MILEPOST 80 TO 83  
USACE JURISDICTION PLAN -10-

GREENMAN-PEDERSEN, INC.  
100 CORPORATE DRIVE, SUITE 301, LEBANON, NJ 08833  
CERTIFICATE OF AUTHORIZATION NO. 24GAZ7959500  
Valerie A Hrabal  
NEW JERSEY TURNPIKE AUTHORITY  
FILE NAME: P-0010\_USACE-P-0010.SHT

SCALE: 1"=50'  
DATE: MAY 2023

NO IMPACTS ON THIS SHEET

REV.	DESCRIPTION	DATE	BY	CHK.

PLANT: 800x400  
TOWN: 4/28/2023 13:11:07  
FILE: P-0010\_USACE-P-0010.SHT  
USER: CORPUS/PAK/2023/USACE-P-0010.SHT

BY	DATE
MADE	SCS 03/2023
TRACED	SCS 03/2023
CHECKED	BEK 03/2023
SUPERVISED	V. HRABAL

ACE-10  
ACE-10

15  
16

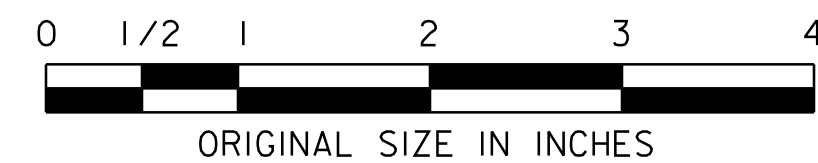
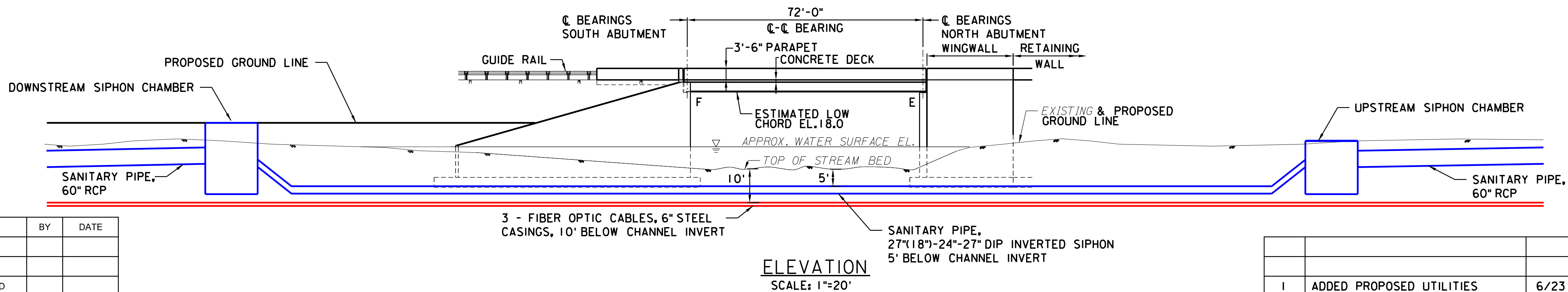
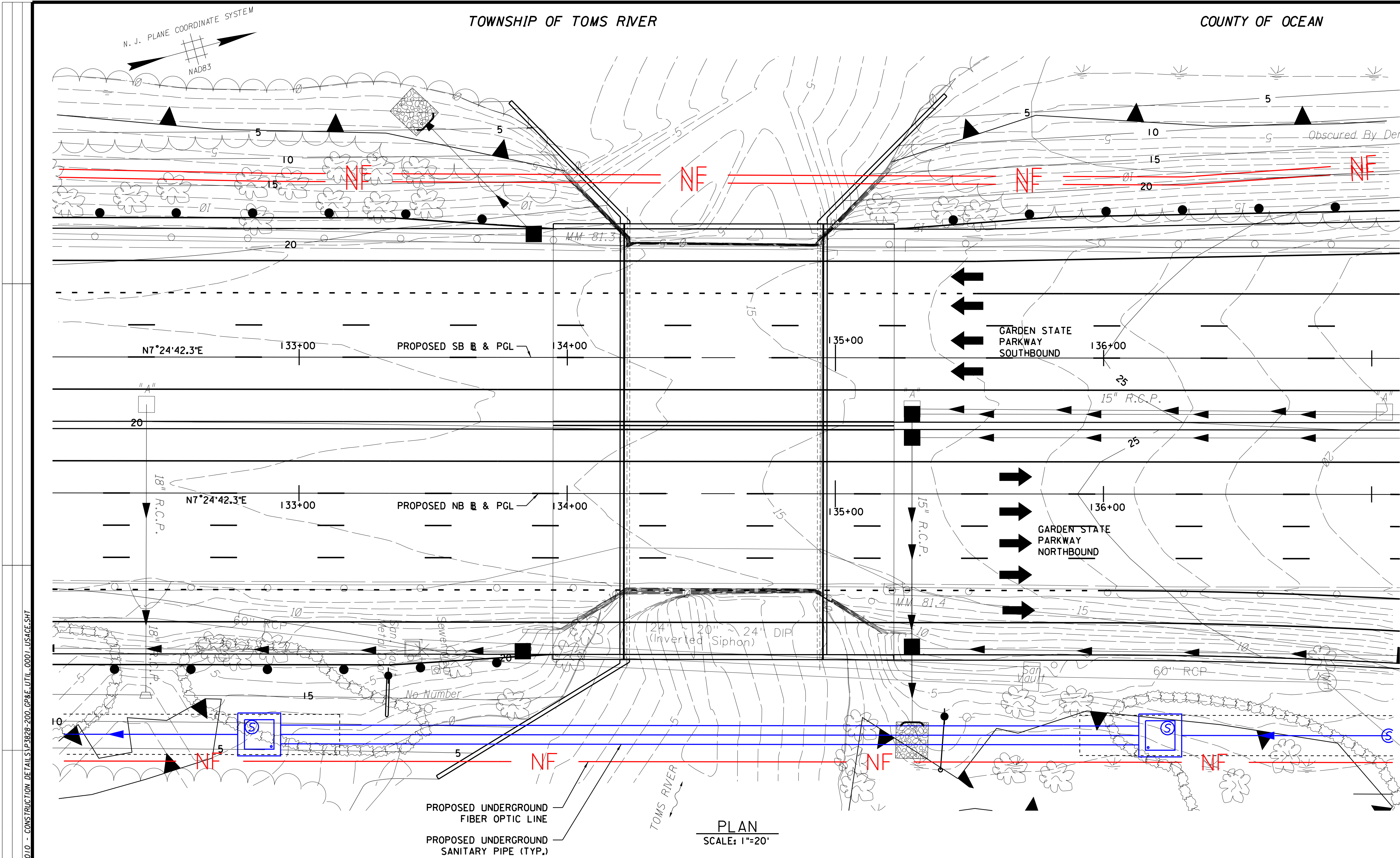

NEW JERSEY TURNPIKE AUTHORITY  
**GARDEN STATE PARKWAY**  
PRELIMINARY ENGINEERING AND ENVIRONMENTAL PERMITTING  
FOR OPERATIONAL IMPROVEMENTS, MILEPOST 80 TO 83

GSP OVER TOMS RIVER  
GENERAL PLAN AND ELEVATION  
BRIDGE NO. 81.4

GREENMAN & PEDERSEN, INC.  
100 CORPORATE DRIVE, SUITE 301, LEBANON, NJ 08833  
CERTIFICATE OF AUTHORIZATION NO. 24GA27959500

VALENTIN A. HRABAL  
NEW JERSEY PROFESSIONAL ENGINEER NO. 24GE02961500

SCALE: AS NOTED  
DATE: MAY 2023

1	ADDED PROPOSED UTILITIES	6/23	SCS	BTS
REV.	DESCRIPTION	DATE	BY	CHK.

FILENAME: C:\3828-200\_GP&E\_UTIL\_0001\_USACE.SHT

PLOT BY: scarvaldi  
PLOT DATE: 6/12/2023 3:33:07 PM  
CADD FILE: S:\2021\655\_GSP\_P3828 - GSP 80 TO 83\CADD\Drawings\Plans\010 - CONSTRUCTION DETAILS\SP3828-200\_GP&E\_UTIL\_0001\_USACE.SHT